

# City of Olean

## ***Zoning Board of Appeals***

P.O. Box 668, 101 E. State Street, room 212  
Olean, New York 14760  
(716) 376-5683

## **A G E N D A**

Zoning Board meeting to be held on Wednesday, November 12, 2025 at 5:45 pm in the City of Olean Municipal Building Council Chambers.

### **I. Meeting**

1. Roll Call
2. Reading and approval of the October 22, 2025 meeting minutes.
3. New Business –
  - 515 Main Street (Area Variances 2025403)
4. Old Business –
  - 138 N. 17<sup>th</sup> Street (Area Variance 2025370)

### **II. Miscellaneous/Communications**

### **III. Adjournment**

# City of Olean

## ***ZONING BOARD OF APPEALS*** P.O. Box 668, 101 East State Street, Room 212 Olean, New York 14760, (716) 376-5683

### **Minutes for Zoning Board Meeting held Wednesday, October 22, 2025** **Olean Municipal Building – Room 119**

Present: Kelly Sweet, Steve Rogers, Bill Eaton, Otto Tertinek, Tom Enright  
Absent: Jim Dwaileebe, Jim Rucinski  
Staff: Shawn Wing, Jacob Herbert  
Other: Harvard Hitchcock

#### **CALL TO ORDER**

K. Sweet called the meeting to order at 5:45 p.m.

#### **ROLL CALL**

T. Enright read roll call. J. Rucinski and J. Dwaileebe were absent.

#### **READING AND APPROVAL OF THE MINUTES FROM August 27, 2025**

B. Eaton noted the misspelling of a public hearing speaker. O. Tertinek noted that T. Enright, not himself, was the reader of the application. B. Eaton made a motion to approve the minutes as amended, seconded by O. Tertinek. Voice vote, all ayes. Motion carried.

#### **NEW BUSINESS**

- **138 N. 17<sup>th</sup> Street (Area Variance #2025370)**

T. Enright read the application from Harvard Hitchcock to request the construction of a six-foot high vinyl fence 32" from the sidewalk. This request will vary from the front yard requirements of a corner lot per Article 28, Section 10.7.5 of the City of Olean Zoning Law.

The Board reviewed the SEQR Part 1. K. Sweet made a motion to classify it as a Type II action, seconded by T. Enright. Voice vote, ayes all. Motion carried.

T. Enright made a motion to set the public hearing date for November 12, 2025 at 5:47 pm, seconded by O. Tertinek. Voice vote, ayes all. Motion carried.

The applicant was noted as present. He briefly explained that he intends to use the proposed fence to prevent further thefts from occurring and to protect his daughter and granddaughter who reside on the property.

## **ADJOURNMENT**

T. Enright made a motion to adjourn at 5:55 pm, seconded by B. Eaton. Voice vote, all ayes.  
Motion carried.

Respectfully submitted,  
Jacob Herbert

DRAFT

**Area Variance**

**515 Main St.**

**City of Olean**  
**Department of Fire, Buildings, & Emergency Services**  
**Code Enforcement Division**

Olean Municipal Building, Rm. 212  
P.O. Box 668, 101 E. State Street  
Olean, NY 14760  
716-376-5683, 716-376-5707 (fax)

**Zoning Permit Application**

To Code Enforcement:

Date: Oct. 29, 2025

I hereby apply for a zoning permit pursuant to the Olean Zoning Ordinance to construct or alter a structure as set forth. This Application may be used in conjunction with any variance applications. Please provide a separate application for each construction project. Please print in ink.

Regarding Address: 515 Main St Olean NY 14760

Owner: Olean General Hospital

Applicant: David Miller

Addr: 515 Main St

Addr: 515 Main St

Olean NY 14760

Olean NY 14760

Phone: 716-373-2600 (h)

(w)

Phone: 716-375-6214 (h)

(w)

If you are applying for a change of use, please complete questions #1 & 6 and continue onto page 2. New construction requires full completion of this application.

1.) Please check one:

☐ a single-family dwelling

☐ a dbl-family dwelling

☐ a multi-family dwelling, number of units? \_\_\_\_\_

☐ currently, vacant land

☒ other (business) Please describe: Hospital

1.) Lot size: Width 420' Depth 520' Area 218,400 sq. ft.

2.) List all of the structures currently on the lot:

(1)

(2)

(3)

(4)

Hospital

Metal Storage Bldg.

(principal bldg)

(describe structure)

(describe structure)

(describe structure)

w) 320 l) 340 h) 60

w) \_\_\_\_\_ l) \_\_\_\_\_ h) \_\_\_\_\_

w) \_\_\_\_\_ l) \_\_\_\_\_ h) \_\_\_\_\_

w) \_\_\_\_\_ l) \_\_\_\_\_ h) \_\_\_\_\_

4.) Are you applying for a New structure OR An addition (Please circle one)

5.) Proposal's dimensions: w) 120 l) 170 h) 13 Stories) 1 Total sq.ft.) 12000

6.) Describe proposal: Construct an additional, appr. 9000 sq ft on the south side of the hospital to expand the emergency dept.

7.) Provide minimum distances from the new construction to the property lines. These measurements should conform to the measurements drawn on the plot plan located on pg. 3. For additions, write the initial "A" where the addition will be attached to the existing structure.

Right distance: Attached to existing structure ft., Left: 12 ft., Both sides total: 12 ft.

Front distance: 160 ft., Rear: 60 ft. to the property line.

If this application is denied, I (owner & applicant) understand that only the appropriate board has the authority to grant permission to vary from the requirements of the City of Olean Zoning Ordinance and NO work will commence until Code Enforcement has issued the permit.

I believe that the statements herein contained on this application (pages 1 – 3) are true to the best of my knowledge.

Owner: \_\_\_\_\_

Applicant: David Miller David Miller Oct 29, 2025  
(print) (signature) (date)

Applicant representing business of: Olean General Hospital

\*\*\*\*\*

#### Code Enforcement Action

This application of Zoning received on 10/31/25 for  
The construction site of 515 Main St. Zoned: R3 according to the City  
Ordinance is hereby **APPROVED** or **DENIED**

If denied, the reason for denial is: part of the building will be  
less than 8' of ROW. They will also expand parking  
in front yard and reduce green space. (u)

The following indicated applications and approvals are required prior to any issuance of permits:

Area Variance Use Variance Home Occupation Special Use Site Plan Other

Code Enforcement Officer: SPER Date: 11/3/25

Comments: they will need 1 year to start the  
project. (u)



lot width 420' lot depth 520' lot area 218,400 bldg. area 68,000

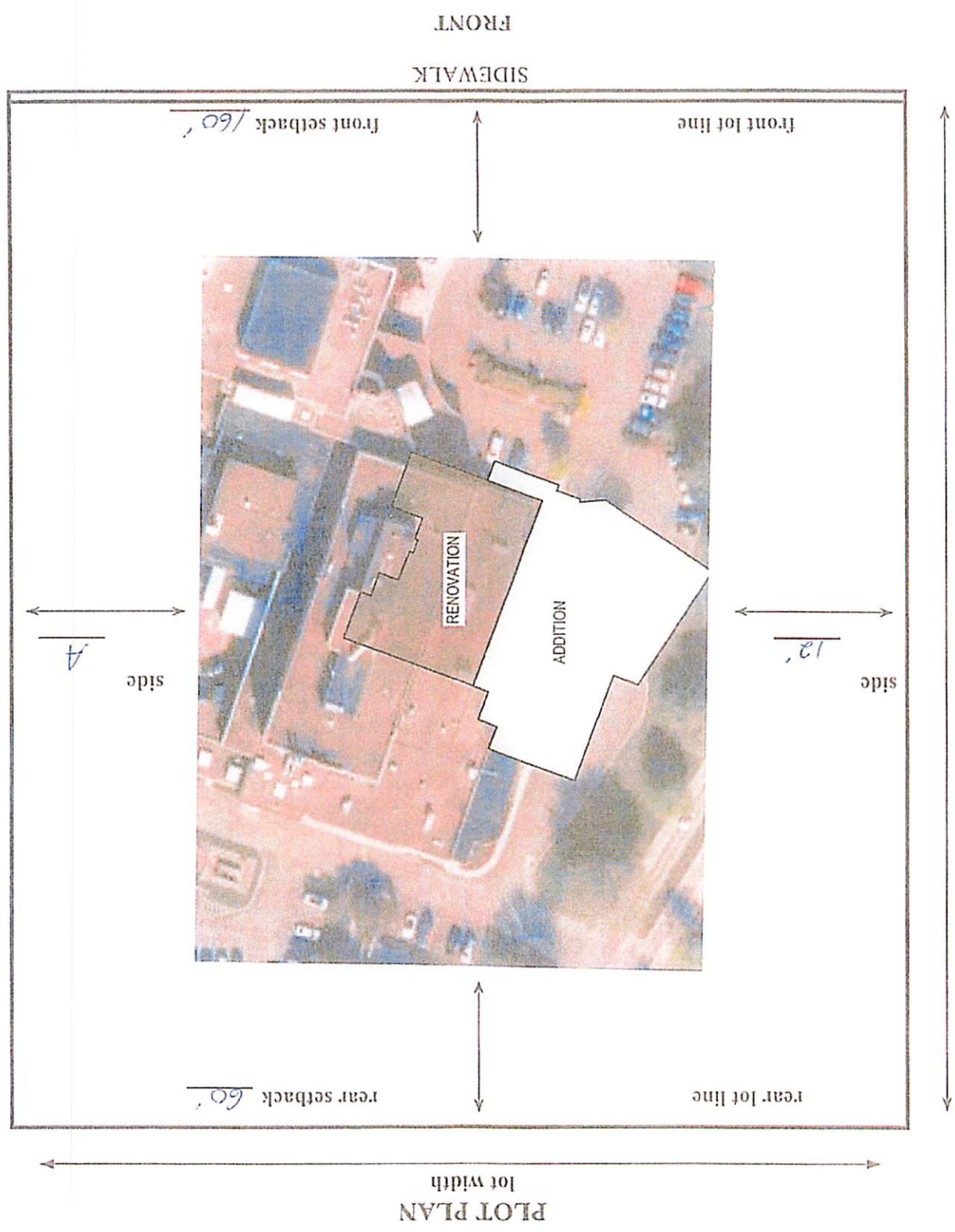

**City of Olean**  
**Department of Fire, Buildings, & Emergency Services**  
**Code Enforcement Division**

Olean Municipal Building, Rm. 212  
P.O. Box 668, 101 E. State Street  
Olean, NY 14760  
716-376-5683, 716-376-5707 (fax)

**Area Variance Application**

Date: October 29, 2025

For Office Use Only  
Application #: 2025403 (a)

Hearing Date/Time: TBD

To: The Zoning Board of Appeals

I Olean General Hospital  
(owner/applicant)

I David Miller Employee - Director of Facilities  
(applicant, if different from owner) (relationship to owner)

hereby make application to the Zoning Board of Appeals for the City of Olean, New York for an Area Variance to

permit the premises known as 515 Main Street Olean NY 14760  
(location)

to vary from the lot area, lot width, yard, height, lot coverage or other dimensional requirement of the Zoning Law.

Detailed description of request: Variance request to construct an  
approximate 12000 sq. ft. addition for ED expansion.  
Variance request will vary from the requirement(s) of:

Article 4 Section 4.2.3 of the Zoning Law.  
Article 6 Section 6.1 of the Zoning Law.

*In making its determination, the Zoning Board of Appeals shall take into consideration the benefit to the applicant if the variance is granted as weighed against the detriment to the health, safety and welfare of the neighborhood or community by such grant. In making determination the Board shall also consider:*

- (1.) whether an undesirable change will be produced in the character of the neighborhood or a detriment to nearby properties will be created by the granting of the area variance;
- (2.) whether the benefit sought by the applicant can be achieved by some method, feasible for the applicant to pursue, other than an area variance;
- (3.) whether the requested area variance is substantial;
- (4.) whether the proposed variance will have an adverse effect or impact on the physical or environmental conditions in the neighborhood or district
- (5.) whether the alleged difficulty was self-created which consideration shall be relevant to the decision of the Board of Appeals, but shall not necessarily preclude the granting of the area variance.

It is the responsibility of the applicant to present evidence sufficient to satisfy the Zoning Board of Appeals that the benefit to the applicant does not outweigh the detriment to the community or neighborhood.

\_\_\_\_\_  
(owner's signature)  
David Miller  
(applicant's signature)

\_\_\_\_\_  
(date)  
October 29, 2025  
(date)



**City of Olean**  
**Department of Fire, Buildings, & Emergency Services**  
**Code Enforcement Division**

Olean Municipal Building, Rm. 212  
P.O. Box 668, 101 E. State Street  
Olean, NY 14760  
716-376-5683, 716-376-5707 (fax)

**Area Variance Application**

Date: October 29 2025

For Office Use Only  
Application #: 2025403 (b)  
Hearing Date/Time: TBD

To: The Zoning Board of Appeals

I Olean General Hospital  
(owner/applicant)

I David Miller  
(applicant, if different from owner)

Employee - Director of Facilities  
(relationship to owner)

hereby make application to the Zoning Board of Appeals for the City of Olean, New York for an Area Variance to

permit the premises known as 515 Main Street Olean NY 14760  
(location)

to vary from the lot area, lot width, yard, height, lot coverage or other dimensional requirement of the Zoning Law.

Detailed description of request: Variance request to expand parking lot  
at the corner of Main St and Front St. Variance for parking in front lawn  
Variance request will vary from the requirement(s) of: and 10% green space

Article 4 Section 4.2.4 of the Zoning Law.  
Article 6 Section 6.1 of the Zoning Law.

*In making its determination, the Zoning Board of Appeals shall take into consideration the benefit to the applicant if the variance is granted as weighed against the detriment to the health, safety and welfare of the neighborhood or community by such grant. In making determination the Board shall also consider:*

- (1.) whether an undesirable change will be produced in the character of the neighborhood or a detriment to nearby properties will be created by the granting of the area variance;
- (2.) whether the benefit sought by the applicant can be achieved by some method, feasible for the applicant to pursue, other than an area variance;
- (3.) whether the requested area variance is substantial;
- (4.) whether the proposed variance will have an adverse effect or impact on the physical or environmental conditions in the neighborhood or district;
- (5.) whether the alleged difficulty was self-created which consideration shall be relevant to the decision of the Board of Appeals, but shall not necessarily preclude the granting of the area variance.

It is the responsibility of the applicant to present evidence sufficient to satisfy the Zoning Board of Appeals that the benefit to the applicant does not outweigh the detriment to the community or neighborhood.

\_\_\_\_\_  
(owner's signature)  
David Miller  
(applicant's signature)

\_\_\_\_\_  
(date)  
October 29, 2025  
(date)

**Full Environmental Assessment Form**  
**Part 1 - Project and Setting**

**Instructions for Completing Part 1**

**Part 1 is to be completed by the applicant or project sponsor.** Responses become part of the application for approval or funding, are subject to public review, and may be subject to further verification.

Complete Part 1 based on information currently available. If additional research or investigation would be needed to fully respond to any item, please answer as thoroughly as possible based on current information; indicate whether missing information does not exist, or is not reasonably available to the sponsor; and, when possible, generally describe work or studies which would be necessary to update or fully develop that information.

Applicants/sponsors must complete all items in Sections A & B. In Sections C, D & E, most items contain an initial question that must be answered either "Yes" or "No". If the answer to the initial question is "Yes", complete the sub-questions that follow. If the answer to the initial question is "No", proceed to the next question. Section F allows the project sponsor to identify and attach any additional information. Section G requires the name and signature of the applicant or project sponsor to verify that the information contained in Part 1 is accurate and complete.

**A. Project and Applicant/Sponsor Information.**

Name of Action or Project: OGH Addition		
Project Location (describe, and attach a general location map): 515 Main St., Olean, NY		
Brief Description of Proposed Action (include purpose or need): 9,000 sq. ft addition		
Name of Applicant/Sponsor: Olean General Hospital		Telephone: 716-373-2600
		E-Mail:
Address: 515 Main Street		
City/PO: Olean	State: NY	Zip Code: 14760
Project Contact (if not same as sponsor; give name and title/role): David Miller - Director of Facilities Services		Telephone: 716-244-1182
		E-Mail: dwmiller@ogh.org
Address: 515 Main Street		
City/PO: Olean	State: NY	Zip Code: 14760
Property Owner (if not same as sponsor):		Telephone:
		E-Mail:
Address:		
City/PO:	State:	Zip Code:

**B. Government Approvals**

<b>B. Government Approvals, Funding, or Sponsorship.</b> ("Funding" includes grants, loans, tax relief, and any other forms of financial assistance.)		
<b>Government Entity</b>	<b>If Yes: Identify Agency and Approval(s) Required</b>	<b>Application Date (Actual or projected)</b>
a. City Council, Town Board, <input type="checkbox"/> Yes <input checked="" type="checkbox"/> No or Village Board of Trustees		
b. City, Town or Village <input checked="" type="checkbox"/> Yes <input type="checkbox"/> No Planning Board or Commission		
c. City, Town or <input checked="" type="checkbox"/> Yes <input type="checkbox"/> No Village Zoning Board of Appeals		
d. Other local agencies <input type="checkbox"/> Yes <input type="checkbox"/> No		
e. County agencies <input type="checkbox"/> Yes <input type="checkbox"/> No		
f. Regional agencies <input type="checkbox"/> Yes <input type="checkbox"/> No		
g. State agencies <input type="checkbox"/> Yes <input type="checkbox"/> No		
h. Federal agencies <input type="checkbox"/> Yes <input type="checkbox"/> No		
i. Coastal Resources.		
i. Is the project site within a Coastal Area, or the waterfront area of a Designated Inland Waterway?		<input type="checkbox"/> Yes <input checked="" type="checkbox"/> No
ii. Is the project site located in a community with an approved Local Waterfront Revitalization Program?		<input type="checkbox"/> Yes <input checked="" type="checkbox"/> No
iii. Is the project site within a Coastal Erosion Hazard Area?		<input type="checkbox"/> Yes <input checked="" type="checkbox"/> No

**C. Planning and Zoning**

<b>C.1. Planning and zoning actions.</b>	
Will administrative or legislative adoption, or amendment of a plan, local law, ordinance, rule or regulation be the only approval(s) which must be granted to enable the proposed action to proceed? <input type="checkbox"/> Yes <input checked="" type="checkbox"/> No	
<ul style="list-style-type: none"><li>• If Yes, complete sections C, F and G.</li><li>• If No, proceed to question C.2 and complete all remaining sections and questions in Part 1</li></ul>	
<b>C.2. Adopted land use plans.</b>	
a. Do any municipally- adopted (city, town, village or county) comprehensive land use plan(s) include the site where the proposed action would be located? <input type="checkbox"/> Yes <input checked="" type="checkbox"/> No	
If Yes, does the comprehensive plan include specific recommendations for the site where the proposed action would be located? <input type="checkbox"/> Yes <input type="checkbox"/> No	
b. Is the site of the proposed action within any local or regional special planning district (for example: Greenway; Brownfield Opportunity Area (BOA); designated State or Federal heritage area; watershed management plan; or other?) <input type="checkbox"/> Yes <input checked="" type="checkbox"/> No	
If Yes, identify the plan(s): _____ _____ _____	
c. Is the proposed action located wholly or partially within an area listed in an adopted municipal open space plan, or an adopted municipal farmland protection plan? <input type="checkbox"/> Yes <input checked="" type="checkbox"/> No	
If Yes, identify the plan(s): _____ _____ _____	

<b>C.3. Zoning</b>	
a. Is the site of the proposed action located in a municipality with an adopted zoning law or ordinance. If Yes, what is the zoning classification(s) including any applicable overlay district? Zoning classification is R3	<input checked="" type="checkbox"/> Yes <input type="checkbox"/> No
b. Is the use permitted or allowed by a special or conditional use permit?	
<input checked="" type="checkbox"/> Yes <input type="checkbox"/> No	
c. Is a zoning change requested as part of the proposed action? If Yes,	
<input type="checkbox"/> Yes <input checked="" type="checkbox"/> No	
i. What is the proposed new zoning for the site?	
<b>C.4. Existing community services.</b>	
a. In what school district is the project site located? <u>City of Olean NY School District</u>	
b. What police or other public protection forces serve the project site? <u>City of Olean Police Department.</u>	
c. Which fire protection and emergency medical services serve the project site? <u>City of Olean Fire Department</u>	
d. What parks serve the project site?	

#### D. Project Details

<b>D.1. Proposed and Potential Development</b>	
a. What is the general nature of the proposed action (e.g., residential, industrial, commercial, recreational; if mixed, include all components)?	
b. a. Total acreage of the site of the proposed action?	_____ acres
b. Total acreage to be physically disturbed?	_____ acres
c. Total acreage (project site and any contiguous properties) owned or controlled by the applicant or project sponsor?	_____ acres
c. Is the proposed action an expansion of an existing project or use?	
<input type="checkbox"/> Yes <input type="checkbox"/> No	
i. If Yes, what is the approximate percentage of the proposed expansion and identify the units (e.g., acres, miles, housing units, square feet)? % _____ Units: _____	
d. Is the proposed action a subdivision, or does it include a subdivision?	
<input type="checkbox"/> Yes <input type="checkbox"/> No	
If Yes,	
i. Purpose or type of subdivision? (e.g., residential, industrial, commercial; if mixed, specify types)	
ii. Is a cluster/conservation layout proposed?	
<input type="checkbox"/> Yes <input type="checkbox"/> No	
iii. Number of lots proposed? _____	
iv. Minimum and maximum proposed lot sizes? Minimum _____ Maximum _____	
e. Will the proposed action be constructed in multiple phases?	
<input type="checkbox"/> Yes <input type="checkbox"/> No	
i. If No, anticipated period of construction: _____ months	
ii. If Yes:	
<ul style="list-style-type: none"> <li>• Total number of phases anticipated _____</li> <li>• Anticipated commencement date of phase 1 (including demolition) _____ month _____ year</li> <li>• Anticipated completion date of final phase _____ month _____ year</li> <li>• Generally describe connections or relationships among phases, including any contingencies where progress of one phase may determine timing or duration of future phases: _____</li> </ul>	

f. Does the project include new residential uses? <span style="float: right;"><input type="checkbox"/> Yes <input type="checkbox"/> No</span> If Yes, show numbers of units proposed.				
	<u>One Family</u>	<u>Two Family</u>	<u>Three Family</u>	<u>Multiple Family (four or more)</u>
Initial Phase	_____	_____	_____	_____
At completion	_____	_____	_____	_____
of all phases	_____	_____	_____	_____

g. Does the proposed action include new non-residential construction (including expansions)? <span style="float: right;"><input type="checkbox"/> Yes <input type="checkbox"/> No</span> If Yes,	
i. Total number of structures _____ ii. Dimensions (in feet) of largest proposed structure: _____ height; _____ width; and _____ length iii. Approximate extent of building space to be heated or cooled: _____ square feet	

h. Does the proposed action include construction or other activities that will result in the impoundment of any liquids, such as creation of a water supply, reservoir, pond, lake, waste lagoon or other storage? <span style="float: right;"><input type="checkbox"/> Yes <input type="checkbox"/> No</span> If Yes,	
i. Purpose of the impoundment: _____ ii. If a water impoundment, the principal source of the water: <input type="checkbox"/> Ground water <input type="checkbox"/> Surface water streams <input type="checkbox"/> Other specify: _____ iii. If other than water, identify the type of impounded/contained liquids and their source. _____ iv. Approximate size of the proposed impoundment. Volume: _____ million gallons; surface area: _____ acres v. Dimensions of the proposed dam or impounding structure: _____ height; _____ length vi. Construction method/materials for the proposed dam or impounding structure (e.g., earth fill, rock, wood, concrete): _____	

**D.2. Project Operations**

a. Does the proposed action include any excavation, mining, or dredging, during construction, operations, or both? (Not including general site preparation, grading or installation of utilities or foundations where all excavated materials will remain onsite) <span style="float: right;"><input type="checkbox"/> Yes <input type="checkbox"/> No</span> If Yes:	
i. What is the purpose of the excavation or dredging? _____ ii. How much material (including rock, earth, sediments, etc.) is proposed to be removed from the site? • Volume (specify tons or cubic yards): _____ • Over what duration of time? _____ iii. Describe nature and characteristics of materials to be excavated or dredged, and plans to use, manage or dispose of them. _____ _____ _____ iv. Will there be onsite dewatering or processing of excavated materials? <span style="float: right;"><input type="checkbox"/> Yes <input type="checkbox"/> No</span> If yes, describe. _____ _____ _____ v. What is the total area to be dredged or excavated? _____ acres vi. What is the maximum area to be worked at any one time? _____ acres vii. What would be the maximum depth of excavation or dredging? _____ feet viii. Will the excavation require blasting? <span style="float: right;"><input type="checkbox"/> Yes <input type="checkbox"/> No</span> ix. Summarize site reclamation goals and plan: _____ _____ _____ _____	

b. Would the proposed action cause or result in alteration of, increase or decrease in size of, or encroachment into any existing wetland, waterbody, shoreline, beach or adjacent area? <span style="float: right;"><input type="checkbox"/> Yes <input type="checkbox"/> No</span> If Yes:	
i. Identify the wetland or waterbody which would be affected (by name, water index number, wetland map number or geographic description): _____ _____ _____	



ii. Describe how the proposed action would affect that waterbody or wetland, e.g. excavation, fill, placement of structures, or alteration of channels, banks and shorelines. Indicate extent of activities, alterations and additions in square feet or acres:

iii. Will the proposed action cause or result in disturbance to bottom sediments?

☐ Yes ☐ No

If Yes, describe:

iv. Will the proposed action cause or result in the destruction or removal of aquatic vegetation?

☐ Yes ☐ No

If Yes:

- acres of aquatic vegetation proposed to be removed: \_\_\_\_\_
- expected acreage of aquatic vegetation remaining after project completion: \_\_\_\_\_
- purpose of proposed removal (e.g. beach clearing, invasive species control, boat access): \_\_\_\_\_
- proposed method of plant removal: \_\_\_\_\_
- if chemical/herbicide treatment will be used, specify product(s): \_\_\_\_\_

v. Describe any proposed reclamation/mitigation following disturbance: \_\_\_\_\_

c. Will the proposed action use, or create a new demand for water?

☐ Yes ☐ No

If Yes:

i. Total anticipated water usage/demand per day: \_\_\_\_\_ gallons/day

ii. Will the proposed action obtain water from an existing public water supply?

☐ Yes ☐ No

If Yes:

- Name of district or service area: \_\_\_\_\_
- Does the existing public water supply have capacity to serve the proposal? ☐ Yes ☐ No
- Is the project site in the existing district? ☐ Yes ☐ No
- Is expansion of the district needed? ☐ Yes ☐ No
- Do existing lines serve the project site? ☐ Yes ☐ No

iii. Will line extension within an existing district be necessary to supply the project?

☐ Yes ☐ No

If Yes:

- Describe extensions or capacity expansions proposed to serve this project: \_\_\_\_\_
- Source(s) of supply for the district: \_\_\_\_\_

iv. Is a new water supply district or service area proposed to be formed to serve the project site?

☐ Yes ☐ No

If Yes:

- Applicant/sponsor for new district: \_\_\_\_\_
- Date application submitted or anticipated: \_\_\_\_\_
- Proposed source(s) of supply for new district: \_\_\_\_\_

v. If a public water supply will not be used, describe plans to provide water supply for the project: \_\_\_\_\_

vi. If water supply will be from wells (public or private), what is the maximum pumping capacity: \_\_\_\_\_ gallons/minute.

d. Will the proposed action generate liquid wastes?

☐ Yes ☐ No

If Yes:

i. Total anticipated liquid waste generation per day: \_\_\_\_\_ gallons/day

ii. Nature of liquid wastes to be generated (e.g., sanitary wastewater, industrial; if combination, describe all components and approximate volumes or proportions of each): \_\_\_\_\_

iii. Will the proposed action use any existing public wastewater treatment facilities?

☐ Yes ☐ No

If Yes:

- Name of wastewater treatment plant to be used: \_\_\_\_\_
- Name of district: \_\_\_\_\_
- Does the existing wastewater treatment plant have capacity to serve the project? ☐ Yes ☐ No
- Is the project site in the existing district? ☐ Yes ☐ No
- Is expansion of the district needed? ☐ Yes ☐ No

<ul style="list-style-type: none"> <li>• Do existing sewer lines serve the project site? <span style="float: right;"><input type="checkbox"/> Yes <input type="checkbox"/> No</span></li> <li>• Will a line extension within an existing district be necessary to serve the project? <span style="float: right;"><input type="checkbox"/> Yes <input type="checkbox"/> No</span></li> </ul> <p>If Yes:</p> <ul style="list-style-type: none"> <li>• Describe extensions or capacity expansions proposed to serve this project: _____</li> </ul>	
<p>iv. Will a new wastewater (sewage) treatment district be formed to serve the project site? <span style="float: right;"><input type="checkbox"/> Yes <input type="checkbox"/> No</span></p> <p>If Yes:</p> <ul style="list-style-type: none"> <li>• Applicant/sponsor for new district: _____</li> <li>• Date application submitted or anticipated: _____</li> <li>• What is the receiving water for the wastewater discharge? _____</li> </ul>	
<p>v. If public facilities will not be used, describe plans to provide wastewater treatment for the project, including specifying proposed receiving water (name and classification if surface discharge or describe subsurface disposal plans):</p> <p>_____</p> <p>_____</p>	
<p>vi. Describe any plans or designs to capture, recycle or reuse liquid waste: _____</p> <p>_____</p> <p>_____</p>	
<p>e. Will the proposed action disturb more than one acre and create stormwater runoff, either from new point sources (i.e. ditches, pipes, swales, curbs, gutters or other concentrated flows of stormwater) or non-point source (i.e. sheet flow) during construction or post construction? <span style="float: right;"><input type="checkbox"/> Yes <input type="checkbox"/> No</span></p> <p>If Yes:</p> <p>i. How much impervious surface will the project create in relation to total size of project parcel?</p> <p style="padding-left: 40px;">_____ Square feet or _____ acres (impervious surface)</p> <p style="padding-left: 40px;">_____ Square feet or _____ acres (parcel size)</p> <p>ii. Describe types of new point sources. _____</p> <p>_____</p> <p>iii. Where will the stormwater runoff be directed (i.e. on-site stormwater management facility/structures, adjacent properties, groundwater, on-site surface water or off-site surface waters)?</p> <p>_____</p> <p>_____</p> <ul style="list-style-type: none"> <li>• If to surface waters, identify receiving water bodies or wetlands: _____</li> <li>_____</li> <li>• Will stormwater runoff flow to adjacent properties? <span style="float: right;"><input type="checkbox"/> Yes <input type="checkbox"/> No</span></li> </ul>	
<p>iv. Does the proposed plan minimize impervious surfaces, use pervious materials or collect and re-use stormwater? <span style="float: right;"><input type="checkbox"/> Yes <input type="checkbox"/> No</span></p>	
<p>f. Does the proposed action include, or will it use on-site, one or more sources of air emissions, including fuel combustion, waste incineration, or other processes or operations? <span style="float: right;"><input type="checkbox"/> Yes <input type="checkbox"/> No</span></p> <p>If Yes, identify:</p> <p>i. Mobile sources during project operations (e.g., heavy equipment, fleet or delivery vehicles)</p> <p>_____</p> <p>ii. Stationary sources during construction (e.g., power generation, structural heating, batch plant, crushers)</p> <p>_____</p> <p>iii. Stationary sources during operations (e.g., process emissions, large boilers, electric generation)</p> <p>_____</p>	
<p>g. Will any air emission sources named in D.2.f (above), require a NY State Air Registration, Air Facility Permit, or Federal Clean Air Act Title IV or Title V Permit? <span style="float: right;"><input type="checkbox"/> Yes <input type="checkbox"/> No</span></p> <p>If Yes:</p> <p>i. Is the project site located in an Air quality non-attainment area? (Area routinely or periodically fails to meet ambient air quality standards for all or some parts of the year) <span style="float: right;"><input type="checkbox"/> Yes <input type="checkbox"/> No</span></p> <p>ii. In addition to emissions as calculated in the application, the project will generate:</p> <ul style="list-style-type: none"> <li>• _____ Tons/year (short tons) of Carbon Dioxide (CO<sub>2</sub>)</li> <li>• _____ Tons/year (short tons) of Nitrous Oxide (N<sub>2</sub>O)</li> <li>• _____ Tons/year (short tons) of Perfluorocarbons (PFCs)</li> <li>• _____ Tons/year (short tons) of Sulfur Hexafluoride (SF<sub>6</sub>)</li> <li>• _____ Tons/year (short tons) of Carbon Dioxide equivalent of Hydrofluorocarbons (HFCs)</li> <li>• _____ Tons/year (short tons) of Hazardous Air Pollutants (HAPs)</li> </ul>	

<p>h. Will the proposed action generate or emit methane (including, but not limited to, sewage treatment plants, landfills, composting facilities)? <span style="float: right;"><input type="checkbox"/> Yes <input type="checkbox"/> No</span></p> <p>If Yes:</p> <p>i. Estimate methane generation in tons/year (metric): _____</p> <p>ii. Describe any methane capture, control or elimination measures included in project design (e.g., combustion to generate heat or electricity, flaring): _____</p>			
<p>i. Will the proposed action result in the release of air pollutants from open-air operations or processes, such as quarry or landfill operations? <span style="float: right;"><input type="checkbox"/> Yes <input type="checkbox"/> No</span></p> <p>If Yes: Describe operations and nature of emissions (e.g., diesel exhaust, rock particulates/dust): _____</p>			
<p>j. Will the proposed action result in a substantial increase in traffic above present levels or generate substantial new demand for transportation facilities or services? <span style="float: right;"><input type="checkbox"/> Yes <input type="checkbox"/> No</span></p> <p>If Yes:</p> <p>i. When is the peak traffic expected (Check all that apply): <input type="checkbox"/> Morning <input type="checkbox"/> Evening <input type="checkbox"/> Weekend  <input type="checkbox"/> Randomly between hours of _____ to _____.</p> <p>ii. For commercial activities only, projected number of truck trips/day and type (e.g., semi trailers and dump trucks): _____</p> <p>iii. Parking spaces: Existing _____ Proposed _____ Net increase/decrease _____</p> <p>iv. Does the proposed action include any shared use parking? <span style="float: right;"><input type="checkbox"/> Yes <input type="checkbox"/> No</span></p> <p>v. If the proposed action includes any modification of existing roads, creation of new roads or change in existing access, describe: _____</p> <p>vi. Are public/private transportation service(s) or facilities available within ½ mile of the proposed site? <span style="float: right;"><input type="checkbox"/> Yes <input type="checkbox"/> No</span></p> <p>vii. Will the proposed action include access to public transportation or accommodations for use of hybrid, electric or other alternative fueled vehicles? <span style="float: right;"><input type="checkbox"/> Yes <input type="checkbox"/> No</span></p> <p>viii. Will the proposed action include plans for pedestrian or bicycle accommodations for connections to existing pedestrian or bicycle routes? <span style="float: right;"><input type="checkbox"/> Yes <input type="checkbox"/> No</span></p>			
<p>k. Will the proposed action (for commercial or industrial projects only) generate new or additional demand for energy? <span style="float: right;"><input type="checkbox"/> Yes <input type="checkbox"/> No</span></p> <p>If Yes:</p> <p>i. Estimate annual electricity demand during operation of the proposed action: _____</p> <p>ii. Anticipated sources/suppliers of electricity for the project (e.g., on-site combustion, on-site renewable, via grid/local utility, or other): _____</p> <p>iii. Will the proposed action require a new, or an upgrade, to an existing substation? <span style="float: right;"><input type="checkbox"/> Yes <input type="checkbox"/> No</span></p>			
<p>l. Hours of operation. Answer all items which apply.</p> <table style="width: 100%;"> <tr> <td style="width: 50%; vertical-align: top;"> <p>i. During Construction:</p> <ul style="list-style-type: none"> <li>• Monday - Friday: _____</li> <li>• Saturday: _____</li> <li>• Sunday: _____</li> <li>• Holidays: _____</li> </ul> </td> <td style="width: 50%; vertical-align: top;"> <p>ii. During Operations:</p> <ul style="list-style-type: none"> <li>• Monday - Friday: _____</li> <li>• Saturday: _____</li> <li>• Sunday: _____</li> <li>• Holidays: _____</li> </ul> </td> </tr> </table>		<p>i. During Construction:</p> <ul style="list-style-type: none"> <li>• Monday - Friday: _____</li> <li>• Saturday: _____</li> <li>• Sunday: _____</li> <li>• Holidays: _____</li> </ul>	<p>ii. During Operations:</p> <ul style="list-style-type: none"> <li>• Monday - Friday: _____</li> <li>• Saturday: _____</li> <li>• Sunday: _____</li> <li>• Holidays: _____</li> </ul>
<p>i. During Construction:</p> <ul style="list-style-type: none"> <li>• Monday - Friday: _____</li> <li>• Saturday: _____</li> <li>• Sunday: _____</li> <li>• Holidays: _____</li> </ul>	<p>ii. During Operations:</p> <ul style="list-style-type: none"> <li>• Monday - Friday: _____</li> <li>• Saturday: _____</li> <li>• Sunday: _____</li> <li>• Holidays: _____</li> </ul>		

<p>m. Will the proposed action produce noise that will exceed existing ambient noise levels during construction, operation, or both? <span style="float: right;"><input type="checkbox"/> Yes <input type="checkbox"/> No</span></p> <p>If yes:</p> <p>i. Provide details including sources, time of day and duration:</p> <p>_____</p>	
<p>ii. Will the proposed action remove existing natural barriers that could act as a noise barrier or screen? <span style="float: right;"><input type="checkbox"/> Yes <input type="checkbox"/> No</span></p> <p>Describe: _____</p> <p>_____</p>	
<p>n. Will the proposed action have outdoor lighting? <span style="float: right;"><input type="checkbox"/> Yes <input type="checkbox"/> No</span></p> <p>If yes:</p> <p>i. Describe source(s), location(s), height of fixture(s), direction/aim, and proximity to nearest occupied structures:</p> <p>_____</p>	
<p>ii. Will proposed action remove existing natural barriers that could act as a light barrier or screen? <span style="float: right;"><input type="checkbox"/> Yes <input type="checkbox"/> No</span></p> <p>Describe: _____</p> <p>_____</p>	
<p>o. Does the proposed action have the potential to produce odors for more than one hour per day? <span style="float: right;"><input type="checkbox"/> Yes <input type="checkbox"/> No</span></p> <p>If Yes, describe possible sources, potential frequency and duration of odor emissions, and proximity to nearest occupied structures: _____</p> <p>_____</p>	
<p>p. Will the proposed action include any bulk storage of petroleum (combined capacity of over 1,100 gallons) or chemical products 185 gallons in above ground storage or any amount in underground storage? <span style="float: right;"><input type="checkbox"/> Yes <input type="checkbox"/> No</span></p> <p>If Yes:</p> <p>i. Product(s) to be stored _____</p> <p>ii. Volume(s) _____ per unit time _____ (e.g., month, year)</p> <p>iii. Generally, describe the proposed storage facilities: _____</p> <p>_____</p>	
<p>q. Will the proposed action (commercial, industrial and recreational projects only) use pesticides (i.e., herbicides, insecticides) during construction or operation? <span style="float: right;"><input type="checkbox"/> Yes <input type="checkbox"/> No</span></p> <p>If Yes:</p> <p>i. Describe proposed treatment(s):</p> <p>_____</p> <p>_____</p>	
<p>ii. Will the proposed action use Integrated Pest Management Practices? <span style="float: right;"><input type="checkbox"/> Yes <input type="checkbox"/> No</span></p>	
<p>r. Will the proposed action (commercial or industrial projects only) involve or require the management or disposal of solid waste (excluding hazardous materials)? <span style="float: right;"><input type="checkbox"/> Yes <input type="checkbox"/> No</span></p> <p>If Yes:</p> <p>i. Describe any solid waste(s) to be generated during construction or operation of the facility:</p> <ul style="list-style-type: none"> <li>• Construction: _____ tons per _____ (unit of time)</li> <li>• Operation : _____ tons per _____ (unit of time)</li> </ul> <p>ii. Describe any proposals for on-site minimization, recycling or reuse of materials to avoid disposal as solid waste:</p> <ul style="list-style-type: none"> <li>• Construction: _____</li> <li>• Operation: _____</li> </ul> <p>iii. Proposed disposal methods/facilities for solid waste generated on-site:</p> <ul style="list-style-type: none"> <li>• Construction: _____</li> <li>• Operation: _____</li> </ul>	

s. Does the proposed action include construction or modification of a solid waste management facility? ☐ Yes ☐ No

If Yes:

i. Type of management or handling of waste proposed for the site (e.g., recycling or transfer station, composting, landfill, or other disposal activities): \_\_\_\_\_

ii. Anticipated rate of disposal/processing:

- \_\_\_\_\_ Tons/month, if transfer or other non-combustion/thermal treatment, or
- \_\_\_\_\_ Tons/hour, if combustion or thermal treatment

iii. If landfill, anticipated site life: \_\_\_\_\_ years

t. Will the proposed action at the site involve the commercial generation, treatment, storage, or disposal of hazardous waste? ☐ Yes ☐ No

If Yes:

i. Name(s) of all hazardous wastes or constituents to be generated, handled or managed at facility: \_\_\_\_\_

ii. Generally describe processes or activities involving hazardous wastes or constituents: \_\_\_\_\_

iii. Specify amount to be handled or generated \_\_\_\_\_ tons/month

iv. Describe any proposals for on-site minimization, recycling or reuse of hazardous constituents: \_\_\_\_\_

v. Will any hazardous wastes be disposed at an existing offsite hazardous waste facility? ☐ Yes ☐ No

If Yes: provide name and location of facility: \_\_\_\_\_

If No: describe proposed management of any hazardous wastes which will not be sent to a hazardous waste facility: \_\_\_\_\_

#### E. Site and Setting of Proposed Action

**E.1. Land uses on and surrounding the project site**

a. Existing land uses.

i. Check all uses that occur on, adjoining and near the project site.

☐ Urban ☐ Industrial ☐ Commercial ☐ Residential (suburban) ☐ Rural (non-farm)

☐ Forest ☐ Agriculture ☐ Aquatic ☐ Other (specify): \_\_\_\_\_

ii. If mix of uses, generally describe: \_\_\_\_\_

b. Land uses and covertypes on the project site.

Land use or Covertypes	Current Acreage	Acreage After Project Completion	Change (Acres +/-)
• Roads, buildings, and other paved or impervious surfaces			
• Forested			
• Meadows, grasslands or brushlands (non-agricultural, including abandoned agricultural)			
• Agricultural (includes active orchards, field, greenhouse etc.)			
• Surface water features (lakes, ponds, streams, rivers, etc.)			
• Wetlands (freshwater or tidal)			
• Non-vegetated (bare rock, earth or fill)			
• Other Describe: _____			



<b>c. Is the project site presently used by members of the community for public recreation?</b> <i>i. If Yes: explain:</i> _____	<input type="checkbox"/> Yes <input type="checkbox"/> No
<b>d. Are there any facilities serving children, the elderly, people with disabilities (e.g., schools, hospitals, licensed day care centers, or group homes) within 1500 feet of the project site?</b> If Yes, <i>i. Identify Facilities:</i> _____ _____	<input type="checkbox"/> Yes <input type="checkbox"/> No
<b>e. Does the project site contain an existing dam?</b> If Yes: <i>i. Dimensions of the dam and impoundment:</i> <ul style="list-style-type: none"> <li>• Dam height: _____ feet</li> <li>• Dam length: _____ feet</li> <li>• Surface area: _____ acres</li> <li>• Volume impounded: _____ gallons OR acre-feet</li> </ul> <i>ii. Dam's existing hazard classification:</i> _____ <i>iii. Provide date and summarize results of last inspection:</i> _____ _____	<input type="checkbox"/> Yes <input type="checkbox"/> No
<b>f. Has the project site ever been used as a municipal, commercial or industrial solid waste management facility, or does the project site adjoin property which is now, or was at one time, used as a solid waste management facility?</b> If Yes: <i>i. Has the facility been formally closed?</i> <ul style="list-style-type: none"> <li>• If yes, cite sources/documentation: _____</li> </ul> <i>ii. Describe the location of the project site relative to the boundaries of the solid waste management facility:</i> _____ _____ <i>iii. Describe any development constraints due to the prior solid waste activities:</i> _____ _____	<input type="checkbox"/> Yes <input type="checkbox"/> No    <input type="checkbox"/> Yes <input type="checkbox"/> No
<b>g. Have hazardous wastes been generated, treated and/or disposed of at the site, or does the project site adjoin property which is now or was at one time used to commercially treat, store and/or dispose of hazardous waste?</b> If Yes: <i>i. Describe waste(s) handled and waste management activities, including approximate time when activities occurred:</i> _____ _____	<input type="checkbox"/> Yes <input type="checkbox"/> No
<b>h. Potential contamination history. Has there been a reported spill at the proposed project site, or have any remedial actions been conducted at or adjacent to the proposed site?</b> If Yes: <i>i. Is any portion of the site listed on the NYSDEC Spills Incidents database or Environmental Site Remediation database? Check all that apply:</i> <div style="display: flex; justify-content: space-between; align-items: flex-start;"> <div style="width: 45%;"> <input type="checkbox"/> Yes – Spills Incidents database  <input type="checkbox"/> Yes – Environmental Site Remediation database  <input type="checkbox"/> Neither database         </div> <div style="width: 50%;">           Provide DEC ID number(s): _____            Provide DEC ID number(s): _____         </div> </div> <i>ii. If site has been subject of RCRA corrective activities, describe control measures:</i> _____ _____ <i>iii. Is the project within 2000 feet of any site in the NYSDEC Environmental Site Remediation database?</i> If yes, provide DEC ID number(s): _____ <i>iv. If yes to (i), (ii) or (iii) above, describe current status of site(s):</i> _____ _____	<input type="checkbox"/> Yes <input type="checkbox"/> No       <input type="checkbox"/> Yes <input type="checkbox"/> No

v. Is the project site subject to an institutional control limiting property uses? <span style="float: right;"><input type="checkbox"/> Yes <input type="checkbox"/> No</span>	
<ul style="list-style-type: none"> <li>• If yes, DEC site ID number: _____</li> <li>• Describe the type of institutional control (e.g., deed restriction or easement): _____</li> <li>• Describe any use limitations: _____</li> <li>• Describe any engineering controls: _____</li> <li>• Will the project affect the institutional or engineering controls in place? <span style="float: right;"><input type="checkbox"/> Yes <input type="checkbox"/> No</span></li> <li>• Explain: _____</li> </ul>	
<b>E.2. Natural Resources On or Near Project Site</b>	
a. What is the average depth to bedrock on the project site? _____ feet	
b. Are there bedrock outcroppings on the project site? <span style="float: right;"><input type="checkbox"/> Yes <input type="checkbox"/> No</span> If Yes, what proportion of the site is comprised of bedrock outcroppings? _____ %	
c. Predominant soil type(s) present on project site: _____ % _____ % _____ %	
d. What is the average depth to the water table on the project site? Average: _____ feet	
e. Drainage status of project site soils: <input type="checkbox"/> Well Drained: _____ % of site <input type="checkbox"/> Moderately Well Drained: _____ % of site <input type="checkbox"/> Poorly Drained: _____ % of site	
f. Approximate proportion of proposed action site with slopes: <input type="checkbox"/> 0-10%: _____ % of site <input type="checkbox"/> 10-15%: _____ % of site <input type="checkbox"/> 15% or greater: _____ % of site	
g. Are there any unique geologic features on the project site? <span style="float: right;"><input type="checkbox"/> Yes <input type="checkbox"/> No</span> If Yes, describe: _____	
h. Surface water features.	
i. Does any portion of the project site contain wetlands or other waterbodies (including streams, rivers, ponds or lakes)? <span style="float: right;"><input type="checkbox"/> Yes <input type="checkbox"/> No</span>	
ii. Do any wetlands or other waterbodies adjoin the project site? <span style="float: right;"><input type="checkbox"/> Yes <input type="checkbox"/> No</span>	
If Yes to either <i>i</i> or <i>ii</i> , continue. If No, skip to E.2.i.	
iii. Are any of the wetlands or waterbodies within or adjoining the project site regulated by any federal, state or local agency? <span style="float: right;"><input type="checkbox"/> Yes <input type="checkbox"/> No</span>	
iv. For each identified regulated wetland and waterbody on the project site, provide the following information:	
<ul style="list-style-type: none"> <li>• Streams: Name _____ Classification _____</li> <li>• Lakes or Ponds: Name _____ Classification _____</li> <li>• Wetlands: Name _____ Approximate Size _____</li> <li>• Wetland No. (if regulated by DEC) _____</li> </ul>	
v. Are any of the above water bodies listed in the most recent compilation of NYS water quality-impaired waterbodies? <span style="float: right;"><input type="checkbox"/> Yes <input type="checkbox"/> No</span>	
If yes, name of impaired water body/bodies and basis for listing as impaired: _____	
i. Is the project site in a designated Floodway? <span style="float: right;"><input type="checkbox"/> Yes <input type="checkbox"/> No</span>	
j. Is the project site in the 100-year Floodplain? <span style="float: right;"><input type="checkbox"/> Yes <input type="checkbox"/> No</span>	
k. Is the project site in the 500-year Floodplain? <span style="float: right;"><input type="checkbox"/> Yes <input type="checkbox"/> No</span>	
l. Is the project site located over, or immediately adjoining, a primary, principal or sole source aquifer? <span style="float: right;"><input type="checkbox"/> Yes <input type="checkbox"/> No</span>	
If Yes:	
i. Name of aquifer: _____	

<p>m. Identify the predominant wildlife species that occupy or use the project site:</p> <p>_____</p> <p>_____</p> <p>_____</p>	
<p>n. Does the project site contain a designated significant natural community? <span style="float: right;"><input type="checkbox"/> Yes <input type="checkbox"/> No</span></p> <p>If Yes:</p> <p>i. Describe the habitat/community (composition, function, and basis for designation): _____</p> <p>ii. Source(s) of description or evaluation: _____</p> <p>iii. Extent of community/habitat:</p> <ul style="list-style-type: none"> <li>• Currently: _____ acres</li> <li>• Following completion of project as proposed: _____ acres</li> <li>• Gain or loss (indicate + or -): _____ acres</li> </ul>	
<p>o. Does project site contain any species of plant or animal that is listed by the federal government or NYS as endangered or threatened, or does it contain any areas identified as habitat for an endangered or threatened species? <span style="float: right;"><input type="checkbox"/> Yes <input type="checkbox"/> No</span></p> <p>If Yes:</p> <p>i. Species and listing (endangered or threatened): _____</p> <p>_____</p> <p>_____</p>	
<p>p. Does the project site contain any species of plant or animal that is listed by NYS as rare, or as a species of special concern? <span style="float: right;"><input type="checkbox"/> Yes <input type="checkbox"/> No</span></p> <p>If Yes:</p> <p>i. Species and listing: _____</p> <p>_____</p>	
<p>q. Is the project site or adjoining area currently used for hunting, trapping, fishing or shell fishing? <span style="float: right;"><input type="checkbox"/> Yes <input type="checkbox"/> No</span></p> <p>If yes, give a brief description of how the proposed action may affect that use: _____</p> <p>_____</p>	
<p><b>E.3. Designated Public Resources On or Near Project Site</b></p>	
<p>a. Is the project site, or any portion of it, located in a designated agricultural district certified pursuant to Agriculture and Markets Law, Article 25-AA, Section 303 and 304? <span style="float: right;"><input type="checkbox"/> Yes <input type="checkbox"/> No</span></p> <p>If Yes, provide county plus district name/number: _____</p>	
<p>b. Are agricultural lands consisting of highly productive soils present? <span style="float: right;"><input type="checkbox"/> Yes <input type="checkbox"/> No</span></p> <p>i. If Yes: acreage(s) on project site? _____</p> <p>ii. Source(s) of soil rating(s): _____</p>	
<p>c. Does the project site contain all or part of, or is it substantially contiguous to, a registered National Natural Landmark? <span style="float: right;"><input type="checkbox"/> Yes <input type="checkbox"/> No</span></p> <p>If Yes:</p> <p>i. Nature of the natural landmark: <input type="checkbox"/> Biological Community <input type="checkbox"/> Geological Feature</p> <p>ii. Provide brief description of landmark, including values behind designation and approximate size/extent: _____</p> <p>_____</p> <p>_____</p>	
<p>d. Is the project site located in or does it adjoin a state listed Critical Environmental Area? <span style="float: right;"><input type="checkbox"/> Yes <input type="checkbox"/> No</span></p> <p>If Yes:</p> <p>i. CEA name: _____</p> <p>ii. Basis for designation: _____</p> <p>iii. Designating agency and date: _____</p>	



**Full Environmental Assessment Form**  
**Part 2 - Identification of Potential Project Impacts**

Agency Use Only [If applicable]	
Project :	2025403
Date :	

**Part 2 is to be completed by the lead agency.** Part 2 is designed to help the lead agency inventory all potential resources that could be affected by a proposed project or action. We recognize that the lead agency's reviewer(s) will not necessarily be environmental professionals. So, the questions are designed to walk a reviewer through the assessment process by providing a series of questions that can be answered using the information found in Part 1. To further assist the lead agency in completing Part 2, the form identifies the most relevant questions in Part 1 that will provide the information needed to answer the Part 2 question. When Part 2 is completed, the lead agency will have identified the relevant environmental areas that may be impacted by the proposed activity.

If the lead agency is a state agency and the action is in any Coastal Area, complete the Coastal Assessment Form before proceeding with this assessment.

**Tips for completing Part 2:**

- Review all of the information provided in Part 1.
- Review any application, maps, supporting materials and the Full EAF Workbook.
- Answer each of the 18 questions in Part 2.
- If you answer "Yes" to a numbered question, please complete all the questions that follow in that section.
- If you answer "No" to a numbered question, move on to the next numbered question.
- Check appropriate column to indicate the anticipated size of the impact.
- Proposed projects that would exceed a numeric threshold contained in a question should result in the reviewing agency checking the box "Moderate to large impact may occur."
- The reviewer is not expected to be an expert in environmental analysis.
- If you are not sure or undecided about the size of an impact, it may help to review the sub-questions for the general question and consult the workbook.
- When answering a question consider all components of the proposed activity, that is, the "whole action".
- Consider the possibility for long-term and cumulative impacts as well as direct impacts.
- Answer the question in a reasonable manner considering the scale and context of the project.

<b>1. Impact on Land</b> Proposed action may involve construction on, or physical alteration of, the land surface of the proposed site. (See Part 1. D.1) <i>If "Yes", answer questions a - j. If "No", move on to Section 2.</i>	<input type="checkbox"/> NO	<input type="checkbox"/> YES	
	Relevant Part I Question(s)	No, or small impact may occur	Moderate to large impact may occur
a. The proposed action may involve construction on land where depth to water table is less than 3 feet.	E2d	<input type="checkbox"/>	<input type="checkbox"/>
b. The proposed action may involve construction on slopes of 15% or greater.	E2f	<input type="checkbox"/>	<input type="checkbox"/>
c. The proposed action may involve construction on land where bedrock is exposed, or generally within 5 feet of existing ground surface.	E2a	<input type="checkbox"/>	<input type="checkbox"/>
d. The proposed action may involve the excavation and removal of more than 1,000 tons of natural material.	D2a	<input type="checkbox"/>	<input type="checkbox"/>
e. The proposed action may involve construction that continues for more than one year or in multiple phases.	D1e	<input type="checkbox"/>	<input type="checkbox"/>
f. The proposed action may result in increased erosion, whether from physical disturbance or vegetation removal (including from treatment by herbicides).	D2e, D2q	<input type="checkbox"/>	<input type="checkbox"/>
g. The proposed action is, or may be, located within a Coastal Erosion hazard area.	B1i	<input type="checkbox"/>	<input type="checkbox"/>
h. Other impacts: _____		<input type="checkbox"/>	<input type="checkbox"/>



<b>2. Impact on Geological Features</b> The proposed action may result in the modification or destruction of, or inhibit access to, any unique or unusual land forms on the site (e.g., cliffs, dunes, minerals, fossils, caves). (See Part 1. E.2.g) <span style="float: right;"><input type="checkbox"/> NO <input type="checkbox"/> YES</span> <i>If "Yes", answer questions a - c. If "No", move on to Section 3.</i>			
	<b>Relevant Part I Question(s)</b>	<b>No, or small impact may occur</b>	<b>Moderate to large impact may occur</b>
a. Identify the specific land form(s) attached: _____	E2g	<input type="checkbox"/>	<input type="checkbox"/>
b. The proposed action may affect or is adjacent to a geological feature listed as a registered National Natural Landmark. Specific feature: _____	E3c	<input type="checkbox"/>	<input type="checkbox"/>
c. Other impacts: _____		<input type="checkbox"/>	<input type="checkbox"/>

<b>3. Impacts on Surface Water</b> The proposed action may affect one or more wetlands or other surface water bodies (e.g., streams, rivers, ponds or lakes). (See Part 1. D.2, E.2.h) <span style="float: right;"><input type="checkbox"/> NO <input type="checkbox"/> YES</span> <i>If "Yes", answer questions a - l. If "No", move on to Section 4.</i>			
	<b>Relevant Part I Question(s)</b>	<b>No, or small impact may occur</b>	<b>Moderate to large impact may occur</b>
a. The proposed action may create a new water body.	D2b, D1h	<input type="checkbox"/>	<input type="checkbox"/>
b. The proposed action may result in an increase or decrease of over 10% or more than a 10 acre increase or decrease in the surface area of any body of water.	D2b	<input type="checkbox"/>	<input type="checkbox"/>
c. The proposed action may involve dredging more than 100 cubic yards of material from a wetland or water body.	D2a	<input type="checkbox"/>	<input type="checkbox"/>
d. The proposed action may involve construction within or adjoining a freshwater or tidal wetland, or in the bed or banks of any other water body.	E2h	<input type="checkbox"/>	<input type="checkbox"/>
e. The proposed action may create turbidity in a waterbody, either from upland erosion, runoff or by disturbing bottom sediments.	D2a, D2h	<input type="checkbox"/>	<input type="checkbox"/>
f. The proposed action may include construction of one or more intake(s) for withdrawal of water from surface water.	D2c	<input type="checkbox"/>	<input type="checkbox"/>
g. The proposed action may include construction of one or more outfall(s) for discharge of wastewater to surface water(s).	D2d	<input type="checkbox"/>	<input type="checkbox"/>
h. The proposed action may cause soil erosion, or otherwise create a source of stormwater discharge that may lead to siltation or other degradation of receiving water bodies.	D2e	<input type="checkbox"/>	<input type="checkbox"/>
i. The proposed action may affect the water quality of any water bodies within or downstream of the site of the proposed action.	E2h	<input type="checkbox"/>	<input type="checkbox"/>
j. The proposed action may involve the application of pesticides or herbicides in or around any water body.	D2q, E2h	<input type="checkbox"/>	<input type="checkbox"/>
k. The proposed action may require the construction of new, or expansion of existing, wastewater treatment facilities.	D1a, D2d	<input type="checkbox"/>	<input type="checkbox"/>

1. Other impacts: _____ _____		<input type="checkbox"/>	<input type="checkbox"/>
----------------------------------	--	--------------------------	--------------------------

<b>4. Impact on groundwater</b> The proposed action may result in new or additional use of ground water, or may have the potential to introduce contaminants to ground water or an aquifer. (See Part 1. D.2.a, D.2.c, D.2.d, D.2.p, D.2.q, D.2.t) <i>If "Yes", answer questions a - h. If "No", move on to Section 5.</i> <div style="text-align: right;"> <input type="checkbox"/> NO      <input type="checkbox"/> YES         </div>			
	<b>Relevant Part I Question(s)</b>	<b>No, or small impact may occur</b>	<b>Moderate to large impact may occur</b>
a. The proposed action may require new water supply wells, or create additional demand on supplies from existing water supply wells.	D2c	<input type="checkbox"/>	<input type="checkbox"/>
b. Water supply demand from the proposed action may exceed safe and sustainable withdrawal capacity rate of the local supply or aquifer. Cite Source: _____	D2c	<input type="checkbox"/>	<input type="checkbox"/>
c. The proposed action may allow or result in residential uses in areas without water and sewer services.	D1a, D2c	<input type="checkbox"/>	<input type="checkbox"/>
d. The proposed action may include or require wastewater discharged to groundwater.	D2d, E2l	<input type="checkbox"/>	<input type="checkbox"/>
e. The proposed action may result in the construction of water supply wells in locations where groundwater is, or is suspected to be, contaminated.	D2c, E1f, E1g, E1h	<input type="checkbox"/>	<input type="checkbox"/>
f. The proposed action may require the bulk storage of petroleum or chemical products over ground water or an aquifer.	D2p, E2l	<input type="checkbox"/>	<input type="checkbox"/>
g. The proposed action may involve the commercial application of pesticides within 100 feet of potable drinking water or irrigation sources.	E2h, D2q, E2l, D2c	<input type="checkbox"/>	<input type="checkbox"/>
h. Other impacts: _____ _____		<input type="checkbox"/>	<input type="checkbox"/>

<b>5. Impact on Flooding</b> The proposed action may result in development on lands subject to flooding. (See Part 1. E.2) <i>If "Yes", answer questions a - g. If "No", move on to Section 6.</i> <div style="text-align: right;"> <input type="checkbox"/> NO      <input type="checkbox"/> YES         </div>			
	<b>Relevant Part I Question(s)</b>	<b>No, or small impact may occur</b>	<b>Moderate to large impact may occur</b>
a. The proposed action may result in development in a designated floodway.	E2i	<input type="checkbox"/>	<input type="checkbox"/>
b. The proposed action may result in development within a 100 year floodplain.	E2j	<input type="checkbox"/>	<input type="checkbox"/>
c. The proposed action may result in development within a 500 year floodplain.	E2k	<input type="checkbox"/>	<input type="checkbox"/>
d. The proposed action may result in, or require, modification of existing drainage patterns.	D2b, D2e	<input type="checkbox"/>	<input type="checkbox"/>
e. The proposed action may change flood water flows that contribute to flooding.	D2b, E2i, E2j, E2k	<input type="checkbox"/>	<input type="checkbox"/>
f. If there is a dam located on the site of the proposed action, is the dam in need of repair, or upgrade?	E1e	<input type="checkbox"/>	<input type="checkbox"/>

g. Other impacts: _____ _____		<input type="checkbox"/>	<input type="checkbox"/>
----------------------------------	--	--------------------------	--------------------------

<b>6. Impacts on Air</b> The proposed action may include a state regulated air emission source. <span style="float: right;"><input type="checkbox"/> NO <input type="checkbox"/> YES</span> (See Part 1. D.2.f., D.2.h, D.2.g) <i>If "Yes", answer questions a - f. If "No", move on to Section 7.</i>			
	Relevant Part I Question(s)	No, or small impact may occur	Moderate to large impact may occur
a. If the proposed action requires federal or state air emission permits, the action may also emit one or more greenhouse gases at or above the following levels: i. More than 1000 tons/year of carbon dioxide (CO <sub>2</sub> ) ii. More than 3.5 tons/year of nitrous oxide (N <sub>2</sub> O) iii. More than 1000 tons/year of carbon equivalent of perfluorocarbons (PFCs) iv. More than .045 tons/year of sulfur hexafluoride (SF <sub>6</sub> ) v. More than 1000 tons/year of carbon dioxide equivalent of hydrochloroflourocarbons (HFCs) emissions vi. 43 tons/year or more of methane	D2g D2g D2g D2g D2g D2h	<input type="checkbox"/> <input type="checkbox"/> <input type="checkbox"/> <input type="checkbox"/> <input type="checkbox"/> <input type="checkbox"/>	<input type="checkbox"/> <input type="checkbox"/> <input type="checkbox"/> <input type="checkbox"/> <input type="checkbox"/> <input type="checkbox"/>
b. The proposed action may generate 10 tons/year or more of any one designated hazardous air pollutant, or 25 tons/year or more of any combination of such hazardous air pollutants.	D2g	<input type="checkbox"/>	<input type="checkbox"/>
c. The proposed action may require a state air registration, or may produce an emissions rate of total contaminants that may exceed 5 lbs. per hour, or may include a heat source capable of producing more than 10 million BTU's per hour.	D2f, D2g	<input type="checkbox"/>	<input type="checkbox"/>
d. The proposed action may reach 50% of any of the thresholds in "a" through "c", above.	D2g	<input type="checkbox"/>	<input type="checkbox"/>
e. The proposed action may result in the combustion or thermal treatment of more than 1 ton of refuse per hour.	D2s	<input type="checkbox"/>	<input type="checkbox"/>
f. Other impacts: _____ _____		<input type="checkbox"/>	<input type="checkbox"/>

<b>7. Impact on Plants and Animals</b> The proposed action may result in a loss of flora or fauna. (See Part 1. E.2. m.-q.) <span style="float: right;"><input type="checkbox"/> NO <input type="checkbox"/> YES</span> <i>If "Yes", answer questions a - j. If "No", move on to Section 8.</i>			
	Relevant Part I Question(s)	No, or small impact may occur	Moderate to large impact may occur
a. The proposed action may cause reduction in population or loss of individuals of any threatened or endangered species, as listed by New York State or the Federal government, that use the site, or are found on, over, or near the site.	E2o	<input type="checkbox"/>	<input type="checkbox"/>
b. The proposed action may result in a reduction or degradation of any habitat used by any rare, threatened or endangered species, as listed by New York State or the federal government.	E2o	<input type="checkbox"/>	<input type="checkbox"/>
c. The proposed action may cause reduction in population, or loss of individuals, of any species of special concern or conservation need, as listed by New York State or the Federal government, that use the site, or are found on, over, or near the site.	E2p	<input type="checkbox"/>	<input type="checkbox"/>
d. The proposed action may result in a reduction or degradation of any habitat used by any species of special concern and conservation need, as listed by New York State or the Federal government.	E2p	<input type="checkbox"/>	<input type="checkbox"/>

e. The proposed action may diminish the capacity of a registered National Natural Landmark to support the biological community it was established to protect.	E3c	<input type="checkbox"/>	<input type="checkbox"/>
f. The proposed action may result in the removal of, or ground disturbance in, any portion of a designated significant natural community. Source: _____	E2n	<input type="checkbox"/>	<input type="checkbox"/>
g. The proposed action may substantially interfere with nesting/breeding, foraging, or over-wintering habitat for the predominant species that occupy or use the project site.	E2m	<input type="checkbox"/>	<input type="checkbox"/>
h. The proposed action requires the conversion of more than 10 acres of forest, grassland or any other regionally or locally important habitat. Habitat type & information source: _____	E1b	<input type="checkbox"/>	<input type="checkbox"/>
i. Proposed action (commercial, industrial or recreational projects, only) involves use of herbicides or pesticides.	D2q	<input type="checkbox"/>	<input type="checkbox"/>
j. Other impacts: _____		<input type="checkbox"/>	<input type="checkbox"/>

<b>8. Impact on Agricultural Resources</b> The proposed action may impact agricultural resources. (See Part 1. E.3.a. and b.) <input type="checkbox"/> NO <input type="checkbox"/> YES <i>If "Yes", answer questions a - h. If "No", move on to Section 9.</i>			
	Relevant Part I Question(s)	No, or small impact may occur	Moderate to large impact may occur
a. The proposed action may impact soil classified within soil group 1 through 4 of the NYS Land Classification System.	E2c, E3b	<input type="checkbox"/>	<input type="checkbox"/>
b. The proposed action may sever, cross or otherwise limit access to agricultural land (includes cropland, hayfields, pasture, vineyard, orchard, etc).	E1a, E1b	<input type="checkbox"/>	<input type="checkbox"/>
c. The proposed action may result in the excavation or compaction of the soil profile of active agricultural land.	E3b	<input type="checkbox"/>	<input type="checkbox"/>
d. The proposed action may irreversibly convert agricultural land to non-agricultural uses, either more than 2.5 acres if located in an Agricultural District, or more than 10 acres if not within an Agricultural District.	E1b, E3a	<input type="checkbox"/>	<input type="checkbox"/>
e. The proposed action may disrupt or prevent installation of an agricultural land management system.	E1 a, E1b	<input type="checkbox"/>	<input type="checkbox"/>
f. The proposed action may result, directly or indirectly, in increased development potential or pressure on farmland.	C2c, C3, D2c, D2d	<input type="checkbox"/>	<input type="checkbox"/>
g. The proposed project is not consistent with the adopted municipal Farmland Protection Plan.	C2c	<input type="checkbox"/>	<input type="checkbox"/>
h. Other impacts: _____		<input type="checkbox"/>	<input type="checkbox"/>

<b>9. Impact on Aesthetic Resources</b> The land use of the proposed action are obviously different from, or are in sharp contrast to, current land use patterns between the proposed project and a scenic or aesthetic resource. (Part 1. E.1.a, E.1.b, E.3.h.) <i>If "Yes", answer questions a - g. If "No", go to Section 10.</i>			
		<input type="checkbox"/> NO	<input type="checkbox"/> YES
	Relevant Part I Question(s)	No, or small impact may occur	Moderate to large impact may occur
a. Proposed action may be visible from any officially designated federal, state, or local scenic or aesthetic resource.	E3h	<input type="checkbox"/>	<input type="checkbox"/>
b. The proposed action may result in the obstruction, elimination or significant screening of one or more officially designated scenic views.	E3h, C2b	<input type="checkbox"/>	<input type="checkbox"/>
c. The proposed action may be visible from publicly accessible vantage points: i. Seasonally (e.g., screened by summer foliage, but visible during other seasons) ii. Year round	E3h	<input type="checkbox"/> <input type="checkbox"/>	<input type="checkbox"/> <input type="checkbox"/>
d. The situation or activity in which viewers are engaged while viewing the proposed action is: i. Routine travel by residents, including travel to and from work ii. Recreational or tourism based activities	E3h E2q, E1c	<input type="checkbox"/> <input type="checkbox"/>	<input type="checkbox"/> <input type="checkbox"/>
e. The proposed action may cause a diminishment of the public enjoyment and appreciation of the designated aesthetic resource.	E3h	<input type="checkbox"/>	<input type="checkbox"/>
f. There are similar projects visible within the following distance of the proposed project: 0-1/2 mile 1/2 -3 mile 3-5 mile 5+ mile	D1a, E1a, D1f, D1g	<input type="checkbox"/>	<input type="checkbox"/>
g. Other impacts: _____ _____		<input type="checkbox"/>	<input type="checkbox"/>

<b>10. Impact on Historic and Archeological Resources</b> The proposed action may occur in or adjacent to a historic or archaeological resource. (Part 1. E.3.e, f. and g.) <i>If "Yes", answer questions a - e. If "No", go to Section 11.</i>			
		<input type="checkbox"/> NO	<input type="checkbox"/> YES
	Relevant Part I Question(s)	No, or small impact may occur	Moderate to large impact may occur
a. The proposed action may occur wholly or partially within, or substantially contiguous to, any buildings, archaeological site or district which is listed on the National or State Register of Historical Places, or that has been determined by the Commissioner of the NYS Office of Parks, Recreation and Historic Preservation to be eligible for listing on the State Register of Historic Places.	E3e	<input type="checkbox"/>	<input type="checkbox"/>
b. The proposed action may occur wholly or partially within, or substantially contiguous to, an area designated as sensitive for archaeological sites on the NY State Historic Preservation Office (SHPO) archaeological site inventory.	E3f	<input type="checkbox"/>	<input type="checkbox"/>
c. The proposed action may occur wholly or partially within, or substantially contiguous to, an archaeological site not included on the NY SHPO inventory. Source: _____	E3g	<input type="checkbox"/>	<input type="checkbox"/>



d. Other impacts: _____ _____		<input type="checkbox"/>	<input type="checkbox"/>
<p>If any of the above (a-d) are answered "Moderate to large impact may occur", continue with the following questions to help support conclusions in Part 3:</p> <p>e.</p> <p>i. The proposed action may result in the destruction or alteration of all or part of the site or property.</p> <p>ii. The proposed action may result in the alteration of the property's setting or integrity.</p> <p>iii. The proposed action may result in the introduction of visual elements which are out of character with the site or property, or may alter its setting.</p>	<p>E3e, E3g, E3f</p> <p>E3e, E3f, E3g, E1a, E1b</p> <p>E3e, E3f, E3g, E3h, C2, C3</p>	<p><input type="checkbox"/></p> <p><input type="checkbox"/></p> <p><input type="checkbox"/></p>	<p><input type="checkbox"/></p> <p><input type="checkbox"/></p> <p><input type="checkbox"/></p>

<p><b>11. Impact on Open Space and Recreation</b></p> <p>The proposed action may result in a loss of recreational opportunities or a reduction of an open space resource as designated in any adopted municipal open space plan. <span style="float: right;"><input type="checkbox"/> NO <input type="checkbox"/> YES</span></p> <p>(See Part 1. C.2.c, E.1.c., E.2.q.)</p> <p><i>If "Yes", answer questions a - e. If "No", go to Section 12.</i></p>			
	<b>Relevant Part I Question(s)</b>	<b>No, or small impact may occur</b>	<b>Moderate to large impact may occur</b>
a. The proposed action may result in an impairment of natural functions, or "ecosystem services", provided by an undeveloped area, including but not limited to stormwater storage, nutrient cycling, wildlife habitat.	D2e, E1b E2h, E2m, E2o, E2n, E2p	<input type="checkbox"/>	<input type="checkbox"/>
b. The proposed action may result in the loss of a current or future recreational resource.	C2a, E1c, C2c, E2q	<input type="checkbox"/>	<input type="checkbox"/>
c. The proposed action may eliminate open space or recreational resource in an area with few such resources.	C2a, C2c E1c, E2q	<input type="checkbox"/>	<input type="checkbox"/>
d. The proposed action may result in loss of an area now used informally by the community as an open space resource.	C2c, E1c	<input type="checkbox"/>	<input type="checkbox"/>
e. Other impacts: _____ _____		<input type="checkbox"/>	<input type="checkbox"/>

<p><b>12. Impact on Critical Environmental Areas</b></p> <p>The proposed action may be located within or adjacent to a critical environmental area (CEA). (See Part 1. E.3.d) <span style="float: right;"><input type="checkbox"/> NO <input type="checkbox"/> YES</span></p> <p><i>If "Yes", answer questions a - c. If "No", go to Section 13.</i></p>			
	<b>Relevant Part I Question(s)</b>	<b>No, or small impact may occur</b>	<b>Moderate to large impact may occur</b>
a. The proposed action may result in a reduction in the quantity of the resource or characteristic which was the basis for designation of the CEA.	E3d	<input type="checkbox"/>	<input type="checkbox"/>
b. The proposed action may result in a reduction in the quality of the resource or characteristic which was the basis for designation of the CEA.	E3d	<input type="checkbox"/>	<input type="checkbox"/>
c. Other impacts: _____ _____		<input type="checkbox"/>	<input type="checkbox"/>

<b>13. Impact on Transportation</b> The proposed action may result in a change to existing transportation systems. <input type="checkbox"/> NO <input type="checkbox"/> YES (See Part 1. D.2.j) <i>If "Yes", answer questions a - f. If "No", go to Section 14.</i>			
	Relevant Part I Question(s)	No, or small impact may occur	Moderate to large impact may occur
a. Projected traffic increase may exceed capacity of existing road network.	D2j	<input type="checkbox"/>	<input type="checkbox"/>
b. The proposed action may result in the construction of paved parking area for 500 or more vehicles.	D2j	<input type="checkbox"/>	<input type="checkbox"/>
c. The proposed action will degrade existing transit access.	D2j	<input type="checkbox"/>	<input type="checkbox"/>
d. The proposed action will degrade existing pedestrian or bicycle accommodations.	D2j	<input type="checkbox"/>	<input type="checkbox"/>
e. The proposed action may alter the present pattern of movement of people or goods.	D2j	<input type="checkbox"/>	<input type="checkbox"/>
f. Other impacts: _____ _____		<input type="checkbox"/>	<input type="checkbox"/>

<b>14. Impact on Energy</b> The proposed action may cause an increase in the use of any form of energy. <input type="checkbox"/> NO <input type="checkbox"/> YES (See Part 1. D.2.k) <i>If "Yes", answer questions a - e. If "No", go to Section 15.</i>			
	Relevant Part I Question(s)	No, or small impact may occur	Moderate to large impact may occur
a. The proposed action will require a new, or an upgrade to an existing, substation.	D2k	<input type="checkbox"/>	<input type="checkbox"/>
b. The proposed action will require the creation or extension of an energy transmission or supply system to serve more than 50 single or two-family residences or to serve a commercial or industrial use.	D1f, D1q, D2k	<input type="checkbox"/>	<input type="checkbox"/>
c. The proposed action may utilize more than 2,500 MWhrs per year of electricity.	D2k	<input type="checkbox"/>	<input type="checkbox"/>
d. The proposed action may involve heating and/or cooling of more than 100,000 square feet of building area when completed.	D1g	<input type="checkbox"/>	<input type="checkbox"/>
e. Other Impacts: _____ _____		<input type="checkbox"/>	<input type="checkbox"/>

<b>15. Impact on Noise, Odor, and Light</b> The proposed action may result in an increase in noise, odors, or outdoor lighting. <input type="checkbox"/> NO <input type="checkbox"/> YES (See Part 1. D.2.m., n., and o.) <i>If "Yes", answer questions a - f. If "No", go to Section 16.</i>			
	Relevant Part I Question(s)	No, or small impact may occur	Moderate to large impact may occur
a. The proposed action may produce sound above noise levels established by local regulation.	D2m	<input type="checkbox"/>	<input type="checkbox"/>
b. The proposed action may result in blasting within 1,500 feet of any residence, hospital, school, licensed day care center, or nursing home.	D2m, E1d	<input type="checkbox"/>	<input type="checkbox"/>
c. The proposed action may result in routine odors for more than one hour per day.	D2o	<input type="checkbox"/>	<input type="checkbox"/>

d. The proposed action may result in light shining onto adjoining properties.	D2n	<input type="checkbox"/>	<input type="checkbox"/>
e. The proposed action may result in lighting creating sky-glow brighter than existing area conditions.	D2n, E1a	<input type="checkbox"/>	<input type="checkbox"/>
f. Other impacts: _____ _____		<input type="checkbox"/>	<input type="checkbox"/>

<b>16. Impact on Human Health</b> The proposed action may have an impact on human health from exposure to new or existing sources of contaminants. (See Part 1.D.2.q., E.1. d. f. g. and h.) <i>If "Yes", answer questions a - m. If "No", go to Section 17.</i> <div style="text-align: right;"> <input type="checkbox"/> NO      <input type="checkbox"/> YES         </div>			
	Relevant Part I Question(s)	No, or small impact may occur	Moderate to large impact may occur
a. The proposed action is located within 1500 feet of a school, hospital, licensed day care center, group home, nursing home or retirement community.	E1d	<input type="checkbox"/>	<input type="checkbox"/>
b. The site of the proposed action is currently undergoing remediation.	E1g, E1h	<input type="checkbox"/>	<input type="checkbox"/>
c. There is a completed emergency spill remediation, or a completed environmental site remediation on, or adjacent to, the site of the proposed action.	E1g, E1h	<input type="checkbox"/>	<input type="checkbox"/>
d. The site of the action is subject to an institutional control limiting the use of the property (e.g., easement or deed restriction).	E1g, E1h	<input type="checkbox"/>	<input type="checkbox"/>
e. The proposed action may affect institutional control measures that were put in place to ensure that the site remains protective of the environment and human health.	E1g, E1h	<input type="checkbox"/>	<input type="checkbox"/>
f. The proposed action has adequate control measures in place to ensure that future generation, treatment and/or disposal of hazardous wastes will be protective of the environment and human health.	D2t	<input type="checkbox"/>	<input type="checkbox"/>
g. The proposed action involves construction or modification of a solid waste management facility.	D2q, E1f	<input type="checkbox"/>	<input type="checkbox"/>
h. The proposed action may result in the unearthing of solid or hazardous waste.	D2q, E1f	<input type="checkbox"/>	<input type="checkbox"/>
i. The proposed action may result in an increase in the rate of disposal, or processing, of solid waste.	D2r, D2s	<input type="checkbox"/>	<input type="checkbox"/>
j. The proposed action may result in excavation or other disturbance within 2000 feet of a site used for the disposal of solid or hazardous waste.	E1f, E1g E1h	<input type="checkbox"/>	<input type="checkbox"/>
k. The proposed action may result in the migration of explosive gases from a landfill site to adjacent off site structures.	E1f, E1g	<input type="checkbox"/>	<input type="checkbox"/>
l. The proposed action may result in the release of contaminated leachate from the project site.	D2s, E1f, D2r	<input type="checkbox"/>	<input type="checkbox"/>
m. Other impacts: _____ _____		<input type="checkbox"/>	<input type="checkbox"/>

<b>17. Consistency with Community Plans</b> The proposed action is not consistent with adopted land use plans. (See Part 1. C.1, C.2. and C.3.) <i>If "Yes", answer questions a - h. If "No", go to Section 18.</i> <div style="text-align: right;"> <input type="checkbox"/> NO      <input type="checkbox"/> YES       </div>			
	Relevant Part I Question(s)	No, or small impact may occur	Moderate to large impact may occur
a. The proposed action's land use components may be different from, or in sharp contrast to, current surrounding land use pattern(s).	C2, C3, D1a E1a, E1b	<input type="checkbox"/>	<input type="checkbox"/>
b. The proposed action will cause the permanent population of the city, town or village in which the project is located to grow by more than 5%.	C2	<input type="checkbox"/>	<input type="checkbox"/>
c. The proposed action is inconsistent with local land use plans or zoning regulations.	C2, C2, C3	<input type="checkbox"/>	<input type="checkbox"/>
d. The proposed action is inconsistent with any County plans, or other regional land use plans.	C2, C2	<input type="checkbox"/>	<input type="checkbox"/>
e. The proposed action may cause a change in the density of development that is not supported by existing infrastructure or is distant from existing infrastructure.	C3, D1c, D1d, D1f, D1d, E1b	<input type="checkbox"/>	<input type="checkbox"/>
f. The proposed action is located in an area characterized by low density development that will require new or expanded public infrastructure.	C4, D2c, D2d D2j	<input type="checkbox"/>	<input type="checkbox"/>
g. The proposed action may induce secondary development impacts (e.g., residential or commercial development not included in the proposed action)	C2a	<input type="checkbox"/>	<input type="checkbox"/>
h. Other: _____ _____		<input type="checkbox"/>	<input type="checkbox"/>

<b>18. Consistency with Community Character</b> The proposed project is inconsistent with the existing community character. (See Part 1. C.2, C.3, D.2, E.3) <i>If "Yes", answer questions a - g. If "No", proceed to Part 3.</i> <div style="text-align: right;"> <input type="checkbox"/> NO      <input type="checkbox"/> YES       </div>			
	Relevant Part I Question(s)	No, or small impact may occur	Moderate to large impact may occur
a. The proposed action may replace or eliminate existing facilities, structures, or areas of historic importance to the community.	E3e, E3f, E3g	<input type="checkbox"/>	<input type="checkbox"/>
b. The proposed action may create a demand for additional community services (e.g. schools, police and fire)	C4	<input type="checkbox"/>	<input type="checkbox"/>
c. The proposed action may displace affordable or low-income housing in an area where there is a shortage of such housing.	C2, C3, D1f D1g, E1a	<input type="checkbox"/>	<input type="checkbox"/>
d. The proposed action may interfere with the use or enjoyment of officially recognized or designated public resources.	C2, E3	<input type="checkbox"/>	<input type="checkbox"/>
e. The proposed action is inconsistent with the predominant architectural scale and character.	C2, C3	<input type="checkbox"/>	<input type="checkbox"/>
f. Proposed action is inconsistent with the character of the existing natural landscape.	C2, C3 E1a, E1b E2g, E2h	<input type="checkbox"/>	<input type="checkbox"/>
g. Other impacts: _____ _____		<input type="checkbox"/>	<input type="checkbox"/>

Project : 2025403

Date :

***Full Environmental Assessment Form***  
***Part 3 - Evaluation of the Magnitude and Importance of Project Impacts***  
***and***  
***Determination of Significance***

Part 3 provides the reasons in support of the determination of significance. The lead agency must complete Part 3 for every question in Part 2 where the impact has been identified as potentially moderate to large or where there is a need to explain why a particular element of the proposed action will not, or may, result in a significant adverse environmental impact.

Based on the analysis in Part 3, the lead agency must decide whether to require an environmental impact statement to further assess the proposed action or whether available information is sufficient for the lead agency to conclude that the proposed action will not have a significant adverse environmental impact. By completing the certification on the next page, the lead agency can complete its determination of significance.

**Reasons Supporting This Determination:**

To complete this section:

- Identify the impact based on the Part 2 responses and describe its magnitude. Magnitude considers factors such as severity, size or extent of an impact.
- Assess the importance of the impact. Importance relates to the geographic scope, duration, probability of the impact occurring, number of people affected by the impact and any additional environmental consequences if the impact were to occur.
- The assessment should take into consideration any design element or project changes.
- Repeat this process for each Part 2 question where the impact has been identified as potentially moderate to large or where there is a need to explain why a particular element of the proposed action will not, or may, result in a significant adverse environmental impact.
- Provide the reason(s) why the impact may, or will not, result in a significant adverse environmental impact
- For Conditional Negative Declarations identify the specific condition(s) imposed that will modify the proposed action so that no significant adverse environmental impacts will result.
- Attach additional sheets, as needed.

**Determination of Significance - Type 1 and Unlisted Actions**

SEQR Status: ☐ Type 1 ☐ Unlisted

Identify portions of EAF completed for this Project: ☐ Part 1 ☐ Part 2 ☐ Part 3

Upon review of the information recorded on this EAF, as noted, plus this additional support information

and considering both the magnitude and importance of each identified potential impact, it is the conclusion of the \_\_\_\_\_ as lead agency that:

☐ A. This project will result in no significant adverse impacts on the environment, and, therefore, an environmental impact statement need not be prepared. Accordingly, this negative declaration is issued.

☐ B. Although this project could have a significant adverse impact on the environment, that impact will be avoided or substantially mitigated because of the following conditions which will be required by the lead agency:

There will, therefore, be no significant adverse impacts from the project as conditioned, and, therefore, this conditioned negative declaration is issued. A conditioned negative declaration may be used only for UNLISTED actions (see 6 NYCRR 617.7(d)).

☐ C. This Project may result in one or more significant adverse impacts on the environment, and an environmental impact statement must be prepared to further assess the impact(s) and possible mitigation and to explore alternatives to avoid or reduce those impacts. Accordingly, this positive declaration is issued.

Name of Action:

Name of Lead Agency:

Name of Responsible Officer in Lead Agency:

Title of Responsible Officer:

Signature of Responsible Officer in Lead Agency:

Date:

Signature of Preparer (if different from Responsible Officer)

Date:

**For Further Information:**

Contact Person:

Address:

Telephone Number:

E-mail:

**For Type 1 Actions and Conditioned Negative Declarations, a copy of this Notice is sent to:**

Chief Executive Officer of the political subdivision in which the action will be principally located (e.g., Town / City / Village of)  
Other involved agencies (if any)

Applicant (if any)

Environmental Notice Bulletin: <http://www.dec.ny.gov/enb/enb.html>

**Area Variance**

**138 N. 17<sup>th</sup> St.**

**City of Olean**  
**Department of Fire, Buildings, & Emergency Services**  
**Code Enforcement Division**

Olean Municipal Building, Rm. 212  
P.O. Box 668, 101 E. State Street  
Olean, NY 14760  
716-376-5683, 716-376-5707 (fax)

**Area Variance Application**

Date: 10/3/2025

For Office Use Only  
Application #: 2025 370

Hearing Date/Time: 11/12/25 5:47 pm

To: The Zoning Board of Appeals

I

HARVARD C. ST. FENCIBER  
(owner/applicant)

I

(applicant, if different from owner)

(relationship to owner)

hereby make application to the Zoning Board of Appeals for the City of Olean, New York for an Area Variance to permit the premises known as 138 N 17<sup>th</sup> st

(location)

to vary from the lot area, lot width, yard, height, lot coverage or other dimensional requirement of the Zoning Law.

Detailed description of request: 72" Vinyl fencing 32" from sidewalk

1 ft 7 in off public right of way. Vary from front yard requirements of corner lot per 28-6.2.

Variance request will vary from the requirement(s) of:

Article 28 Section 10.7.5 of the Zoning Law.  
Article \_\_\_\_\_ Section \_\_\_\_\_ of the Zoning Law.

*In making its determination, the Zoning Board of Appeals shall take into consideration the benefit to the applicant if the variance is granted as weighed against the detriment to the health, safety and welfare of the neighborhood or community by such grant. In making determination the Board shall also consider:*

- (1.) whether an undesirable change will be produced in the character of the neighborhood or a detriment to nearby properties will be created by the granting of the area variance;
- (2.) whether the benefit sought by the applicant can be achieved by some method, feasible for the applicant to pursue, other than an area variance;
- (3.) whether the requested area variance is substantial;
- (4.) whether the proposed variance will have an adverse effect or impact on the physical or environmental conditions in the neighborhood or district
- (5.) whether the alleged difficulty was self-created which consideration shall be relevant to the decision of the Board of Appeals, but shall not necessarily preclude the granting of the area variance.

It is the responsibility of the applicant to present evidence sufficient to satisfy the Zoning Board of Appeals that the benefit to the applicant does not outweigh the detriment to the community or neighborhood.

[Signature]  
(owner's signature)

10/3/2025  
(date)

Cody [Signature]  
(applicant's signature)

9-29-25  
(date)



**City of Olean**  
**Department of Fire, Buildings, & Emergency Services**  
**Code Enforcement Division**

Olean Municipal Building, Rm. 212

P.O. Box 668, 101 E. State Street

Olean, NY 14760

716-376-5683, 716-376-5707 (fax)

www.cityofolean.org

[codes@cityofolean.org](mailto:codes@cityofolean.org)

**Zoning Permit Application**

To Code Enforcement:

Date: 9-29-25

I hereby apply for a zoning permit pursuant to the Olean Zoning Ordinance to construct or alter a structure as setforth. This Application may be used in conjunction with any variance applications. Please provide a separate application for each construction project. Please print in ink.

Regarding Address: 138 N 17<sup>th</sup> St

Owner: Harvard Hitchcock

Applicant: Suburban fence

E-mail: Suburbanfence@gmail.com

E-mail: Suburbanfence18@gmail.com

Addr: 138 N 17<sup>th</sup> St

Addr: 30 Gilbert Ln

Olean NY

Bradford PA 16701

Phone: 716 378 4154 (h) \_\_\_\_\_ (w) \_\_\_\_\_

Phone: 814 596 2344 (h) \_\_\_\_\_ (w) \_\_\_\_\_

If you are applying for a change of use, please complete questions #1 & 6 and continue onto page 2. New construction requires full completion of this application.

1.) Please check one:

- ☒ a single-family dwelling  
☐ a dbl-family dwelling  
☐ a multi-family dwelling, number of units? \_\_\_\_\_  
☐ currently, vacant land  
☐ other (business) Please describe: \_\_\_\_\_

1.) Lot size: Width 40 Depth 105 Area 4200 sq. ft.

2.) List all of the structures currently on the lot:

(1)	(2)	(3)	(4)
(principal bldg)	(describe structure)	(describe structure)	(describe structure)
w) _____ l) _____ h) _____	w) _____ l) _____ h) _____	w) _____ l) _____ h) _____	w) _____ l) _____ h) _____

4.) Are you applying for a New structure OR An addition (Please circle one)

5.) Proposal's dimensions: w) \_\_\_\_\_ l) 149' h) 72" Stories) \_\_\_\_\_ Total sq.ft.) \_\_\_\_\_

6.) Describe proposal: 6' Vinyl fencing / 32" from side walk / 1ft 7in off public right of way. Vary from front yard requirements of corner lot per 28-6.2.

7.) Provide minimum distances from the new construction to the property lines. These measurements should conform to the measurements drawn on the plot plan located on pg. 3. For additions, write the initial "A" where the addition will be attached to the existing structure.

Right distance: \_\_\_\_\_ ft., Left: \_\_\_\_\_ ft., Both sides total: \_\_\_\_\_ ft.

Front distance: \_\_\_\_\_ ft., Rear: \_\_\_\_\_ ft. to the property line.

If this application is denied, I (owner & applicant) understand that only the appropriate board has the authority to grant permission to vary from the requirements of the City of Olean Zoning Ordinance and NO work will commence until Code Enforcement has issued the permit.

I believe that the statements herein contained on this application (pages 1 – 3) are true to the best of my knowledge.

Owner:

(print)

(signature)

(date)

Applicant:

(print)

(signature)

(date)

Applicant representing business of:

\*\*\*\*\*

### Code Enforcement Action

This application of Building Zoning received on 10/3/2025 for  
The construction site of 138 N 17th Zoned: R3 according to the City  
Ordinance is hereby **APPROVED** or **DENIED**

If denied, the reason for denial is: Fence over height regulation (SW)

The following indicated applications and approvals are required prior to any issuance of permits:

Area Variance    Use Variance    Home Occupation    Special Use    Site Plan    Other

Code Enforcement Officer: Shawn Wing Date: 10/3/2025

Comments: n/a (SW)

**Olean Municipal Building**  
P.O. Box 668, 101 E. State Street  
Olean, NY 14760

**Please submit the following items with application:**

**PLOT PLAN**  
lot width

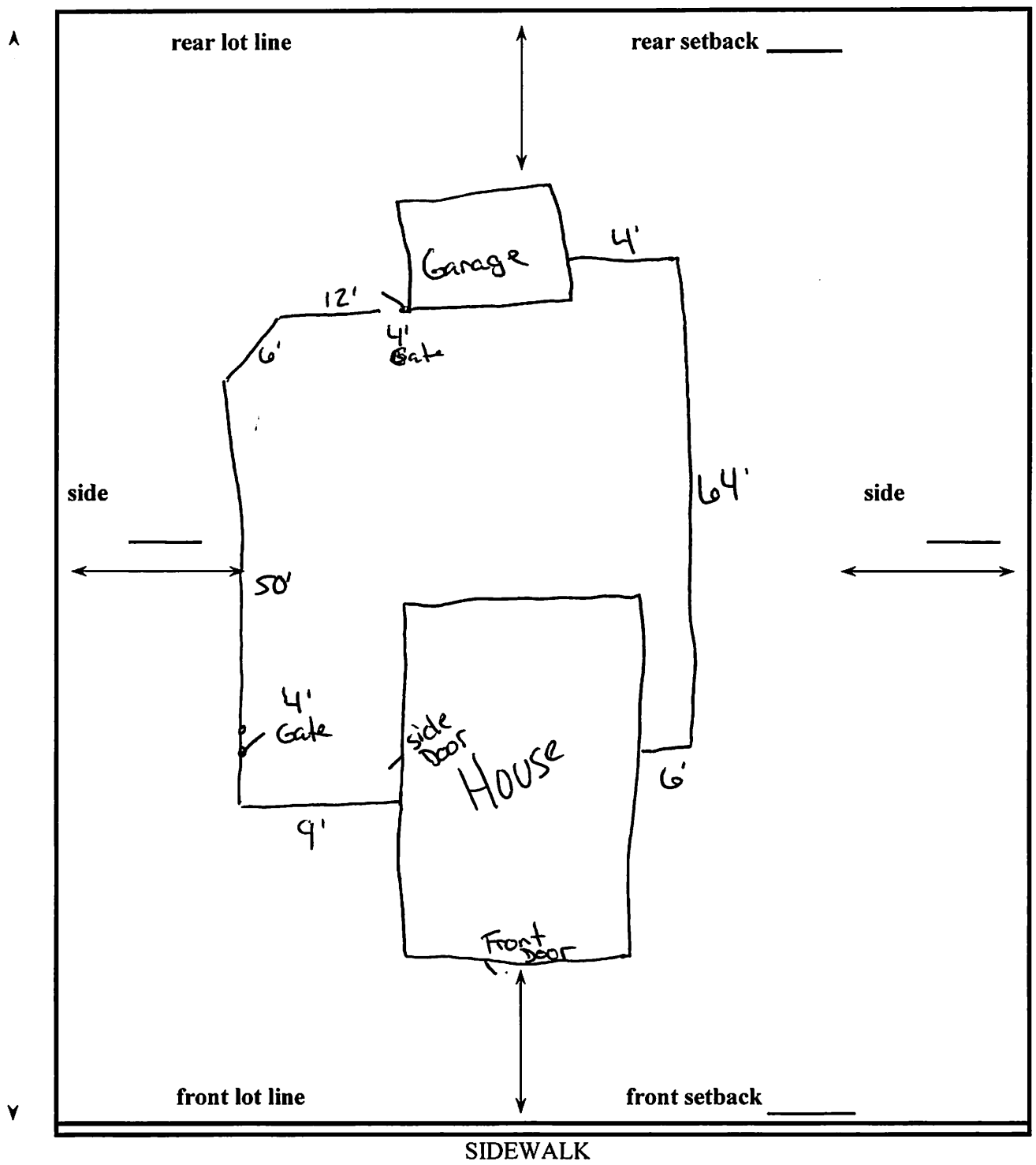

lot width \_\_\_\_\_ lot depth \_\_\_\_\_ lot area \_\_\_\_\_ bldg. area \_\_\_\_\_

Sec 6.1

**City of Olean Zoning Law – Density Control Table**

Use District	Minimum Lot Area (sq. ft.)	Minimum Lot Width (ft.)	Minimum Yard Requirements (ft.)			Maximum Lot Coverage			Maximum Building Height (Feet/Stories)	Minimum Building Separation on Same Lot (ft.)
			Front	Side	Rear	Principal Use (%)	Garage Use (%)	Accessory Use (%)		
R1	9,000	60	25	4*	35	25	7	2	40 3	5
R2	6,000	50	20	4**	20	30	10	2	40 3	5
R3	4,000	40	15	4**	10	35	12	5	40 3	5
RT	4,000	40	15	4**	10	50	12	10	40 3	0
CC	2,000	30	0	0	0	50	12	10	75 3	0
GC	2,000	30	0	0	0	50	12	10	40 3	0
WC	4,000	40	15	4**	10	35	12	5	40 3	5
I	N/A	N/A	50	N/A	N/A	50	12	10	75 N/A	0
I2	N/A	N/A	50	N/A	N/A	50	12	10	75 N/A	0***
I3	N/A	N/A	50	20****	10****	50	12	10	75 N/A	0***
PR	10,000	100	40	20	10	25	10	10	30 2	5
PB	N/A	N/A	N/A	N/A	N/A	25	10	10	40 3	5

\* The minimum width required for a side yard is 4 feet on any side, with both sides together totaling a minimum of 25 feet.

\*\* The minimum width required for a side yard is 4 feet on any side, with both sides together totaling a minimum of 14 feet.

\*\*\* See Section 10.22 for minimum separation distance requirements between adult uses and other specific uses.

\*\*\*\* These setbacks shall be doubled for any parcel that is adjacent to a residentially zoned area.

# Short Environmental Assessment Form

## Part 1 - Project Information

### Instructions for Completing

**Part 1 – Project Information.** The applicant or project sponsor is responsible for the completion of Part 1. Responses become part of the application for approval or funding, are subject to public review, and may be subject to further verification. Complete Part 1 based on information currently available. If additional research or investigation would be needed to fully respond to any item, please answer as thoroughly as possible based on current information.

Complete all items in Part 1. You may also provide any additional information which you believe will be needed by or useful to the lead agency; attach additional pages as necessary to supplement any item.

<b>Part 1 – Project and Sponsor Information</b>			
Name of Action or Project: Hitchcock Fence			
Project Location (describe, and attach a location map): 138 N 17th St, Olean, NY 14760			
Brief Description of Proposed Action: install 144' of fencing			
Name of Applicant or Sponsor: Harvard Hitchcock		Telephone: 7163784154	
		E-Mail:	
Address: 138 N 17th St			
City/PO: Olean		State: NY	Zip Code: 14760
1. Does the proposed action only involve the legislative adoption of a plan, local law, ordinance, administrative rule, or regulation? If Yes, attach a narrative description of the intent of the proposed action and the environmental resources that may be affected in the municipality and proceed to Part 2. If no, continue to question 2.			NO <input checked="" type="checkbox"/>
2. Does the proposed action require a permit, approval or funding from any other government Agency? If Yes, list agency(s) name and permit or approval: Zoning Board of Appeals & Code Enforcement			YES <input checked="" type="checkbox"/>
3. a. Total acreage of the site of the proposed action? _____ .09 acres b. Total acreage to be physically disturbed? _____ .01 acres c. Total acreage (project site and any contiguous properties) owned or controlled by the applicant or project sponsor? _____ .09 acres			
4. Check all land uses that occur on, are adjoining or near the proposed action:			
5. <input type="checkbox"/> Urban <input type="checkbox"/> Rural (non-agriculture) <input type="checkbox"/> Industrial <input type="checkbox"/> Commercial <input checked="" type="checkbox"/> Residential (suburban) <input type="checkbox"/> Forest <input type="checkbox"/> Agriculture <input type="checkbox"/> Aquatic <input type="checkbox"/> Other(Specify): <input type="checkbox"/> Parkland			

5. Is the proposed action,	NO	YES	N/A
a. A permitted use under the zoning regulations?	<input checked="" type="checkbox"/>	<input type="checkbox"/>	<input type="checkbox"/>
b. Consistent with the adopted comprehensive plan?	<input checked="" type="checkbox"/>	<input type="checkbox"/>	<input type="checkbox"/>
6. Is the proposed action consistent with the predominant character of the existing built or natural landscape?	NO	YES	
	<input checked="" type="checkbox"/>	<input type="checkbox"/>	
7. Is the site of the proposed action located in, or does it adjoin, a state listed Critical Environmental Area?	NO	YES	
If Yes, identify: _____	<input checked="" type="checkbox"/>	<input type="checkbox"/>	
8. a. Will the proposed action result in a substantial increase in traffic above present levels?	NO	YES	
	<input checked="" type="checkbox"/>	<input type="checkbox"/>	
b. Are public transportation services available at or near the site of the proposed action?	<input type="checkbox"/>	<input checked="" type="checkbox"/>	
c. Are any pedestrian accommodations or bicycle routes available on or near the site of the proposed action?	<input type="checkbox"/>	<input checked="" type="checkbox"/>	
9. Does the proposed action meet or exceed the state energy code requirements?	NO	YES	
If the proposed action will exceed requirements, describe design features and technologies: _____ _____	<input checked="" type="checkbox"/>	<input type="checkbox"/>	
10. Will the proposed action connect to an existing public/private water supply?	NO	YES	
If No, describe method for providing potable water: _____ _____	<input checked="" type="checkbox"/>	<input type="checkbox"/>	
11. Will the proposed action connect to existing wastewater utilities?	NO	YES	
If No, describe method for providing wastewater treatment: _____ _____	<input checked="" type="checkbox"/>	<input type="checkbox"/>	
12. a. Does the project site contain, or is it substantially contiguous to, a building, archaeological site, or district which is listed on the National or State Register of Historic Places, or that has been determined by the Commissioner of the NYS Office of Parks, Recreation and Historic Preservation to be eligible for listing on the State Register of Historic Places?	NO	YES	
	<input checked="" type="checkbox"/>	<input type="checkbox"/>	
b. Is the project site, or any portion of it, located in or adjacent to an area designated as sensitive for archaeological sites on the NY State Historic Preservation Office (SHPO) archaeological site inventory?	<input type="checkbox"/>	<input checked="" type="checkbox"/>	
13. a. Does any portion of the site of the proposed action, or lands adjoining the proposed action, contain wetlands or other waterbodies regulated by a federal, state or local agency?	NO	YES	
	<input checked="" type="checkbox"/>	<input type="checkbox"/>	
b. Would the proposed action physically alter, or encroach into, any existing wetland or waterbody?	<input checked="" type="checkbox"/>	<input type="checkbox"/>	
If Yes, identify the wetland or waterbody and extent of alterations in square feet or acres: _____ _____ _____			

14. Identify the typical habitat types that occur on, or are likely to be found on the project site. Check all that apply: <input type="checkbox"/> Shoreline <input type="checkbox"/> Forest <input type="checkbox"/> Agricultural/grasslands <input type="checkbox"/> Early mid-successional <input type="checkbox"/> Wetland <input type="checkbox"/> Urban <input checked="" type="checkbox"/> Suburban		
15. Does the site of the proposed action contain any species of animal, or associated habitats, listed by the State or Federal government as threatened or endangered?	NO	YES
	<input checked="" type="checkbox"/>	<input type="checkbox"/>
16. Is the project site located in the 100-year flood plan?	NO	YES
	<input checked="" type="checkbox"/>	<input type="checkbox"/>
17. Will the proposed action create storm water discharge, either from point or non-point sources? If Yes,	NO	YES
	<input checked="" type="checkbox"/>	<input type="checkbox"/>
a. Will storm water discharges flow to adjacent properties?	<input checked="" type="checkbox"/>	<input type="checkbox"/>
b. Will storm water discharges be directed to established conveyance systems (runoff and storm drains)? If Yes, briefly describe:	<input checked="" type="checkbox"/>	<input type="checkbox"/>
_____		
_____		
18. Does the proposed action include construction or other activities that would result in the impoundment of water or other liquids (e.g., retention pond, waste lagoon, dam)? If Yes, explain the purpose and size of the impoundment:	NO	YES
	<input checked="" type="checkbox"/>	<input type="checkbox"/>
_____		
_____		
19. Has the site of the proposed action or an adjoining property been the location of an active or closed solid waste management facility? If Yes, describe:	NO	YES
	<input checked="" type="checkbox"/>	<input type="checkbox"/>
_____		
_____		
20. Has the site of the proposed action or an adjoining property been the subject of remediation (ongoing or completed) for hazardous waste? If Yes, describe:	NO	YES
	<input checked="" type="checkbox"/>	<input type="checkbox"/>
_____		
_____		
<b>I CERTIFY THAT THE INFORMATION PROVIDED ABOVE IS TRUE AND ACCURATE TO THE BEST OF MY KNOWLEDGE</b>  Applicant/sponsor/name: <u>Cody Waite   Suburban Fence</u> Date: <u>9-29-25</u> Signature: <u>Cody Waite</u> Title: <u>owner</u>		



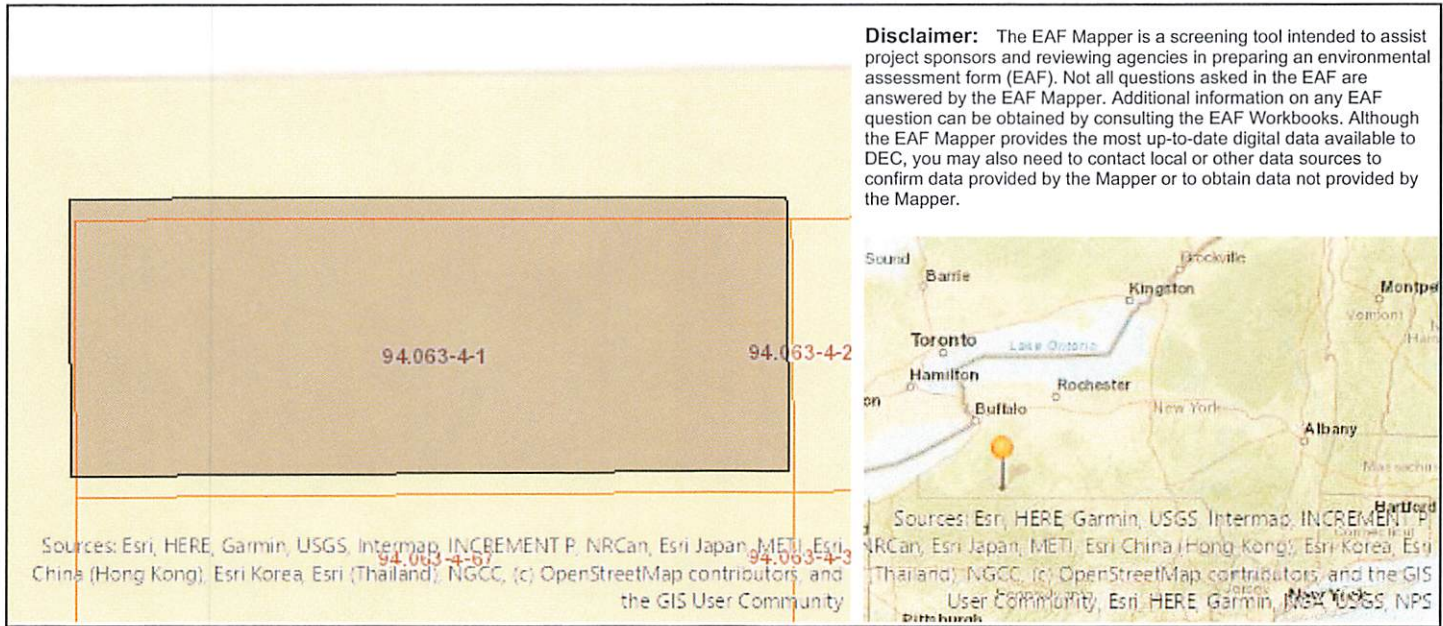

Part 1 / Question 7 [Critical Environmental Area]	No
Part 1 / Question 12a [National or State Register of Historic Places or State Eligible Sites]	No
Part 1 / Question 12b [Archeological Sites]	Yes
Part 1 / Question 13a [Wetlands or Other Regulated Waterbodies]	Digital mapping data are not available or are incomplete. Refer to EAF Workbook.
Part 1 / Question 15 [Threatened or Endangered Animal]	No
Part 1 / Question 16 [100 Year Flood Plain]	Digital mapping data are not available or are incomplete. Refer to EAF Workbook.
Part 1 / Question 20 [Remediation Site]	No