

Rick Schmidt

From: Kenny Helgerson <helgerson.kenny@gmail.com>
Sent: Wednesday, April 22, 2026 5:17 PM
To: Rick Schmidt
Subject: Sewer Usage

Dear Rick Schmidt and The Public Works Department,

I am writing to request a review and adjustment of my recent sewer charges based on average usage.

Due to a substantial leak that has now been fixed, our current utility bill does not accurately reflect water usage entering the sewer system. Because sewer charges are generally intended to reflect wastewater discharge into the sewer system, I respectfully request that my account be evaluated and adjusted to an average usage amount. Please find proof of leak not entering the sewer system in the attachments below.

If needed, I am happy to provide any additional information, including past billing statements, details regarding unusual water usage, or other photo documentation to support this request.



IMG_1161.mov



IMG_1170.jpeg



IMG_1171.mov



IMG_1172.jpeg



IMG_1173.jpeg

Please let me know if there are any forms to complete or further steps required to process this adjustment. I appreciate your time and consideration in reviewing my request.







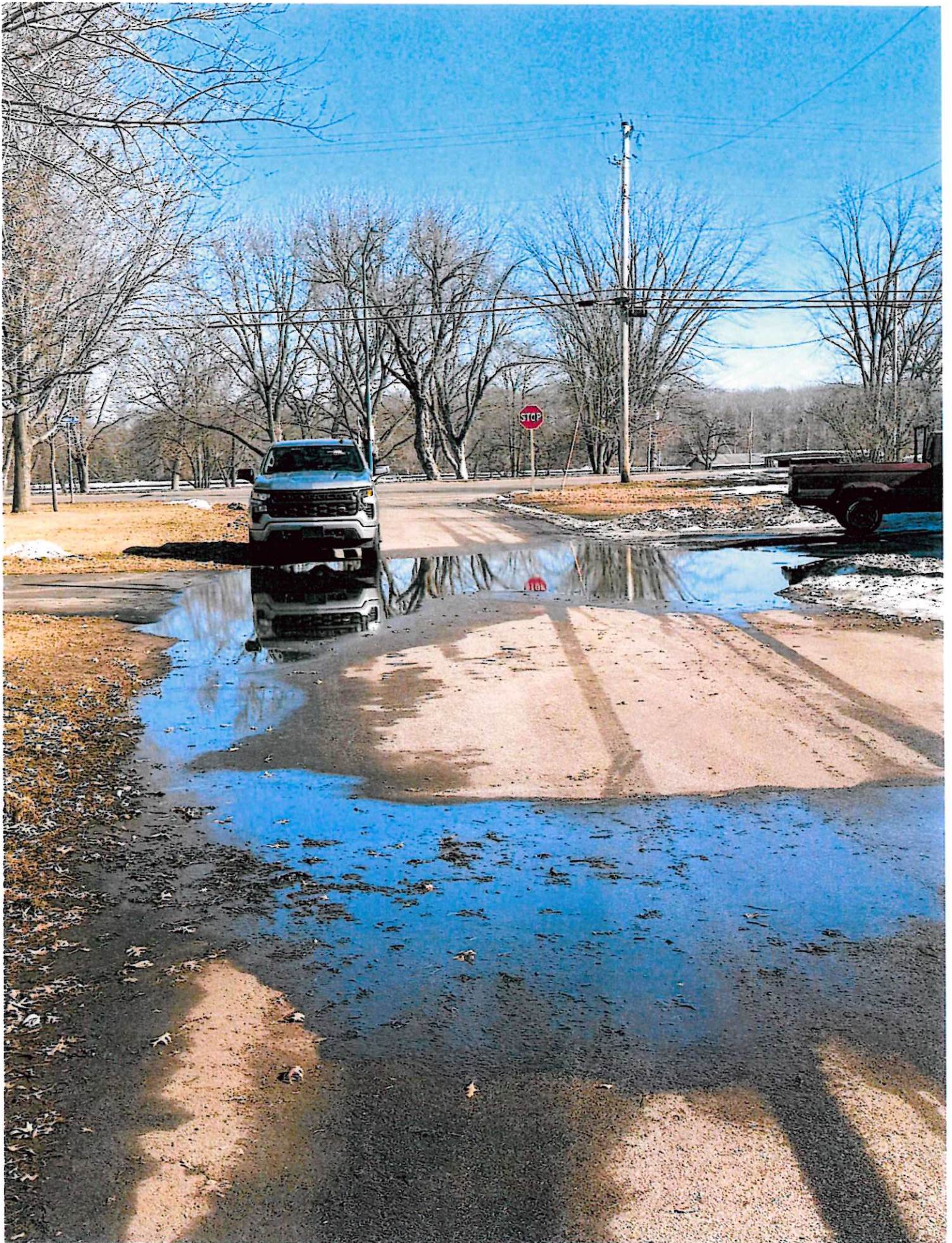



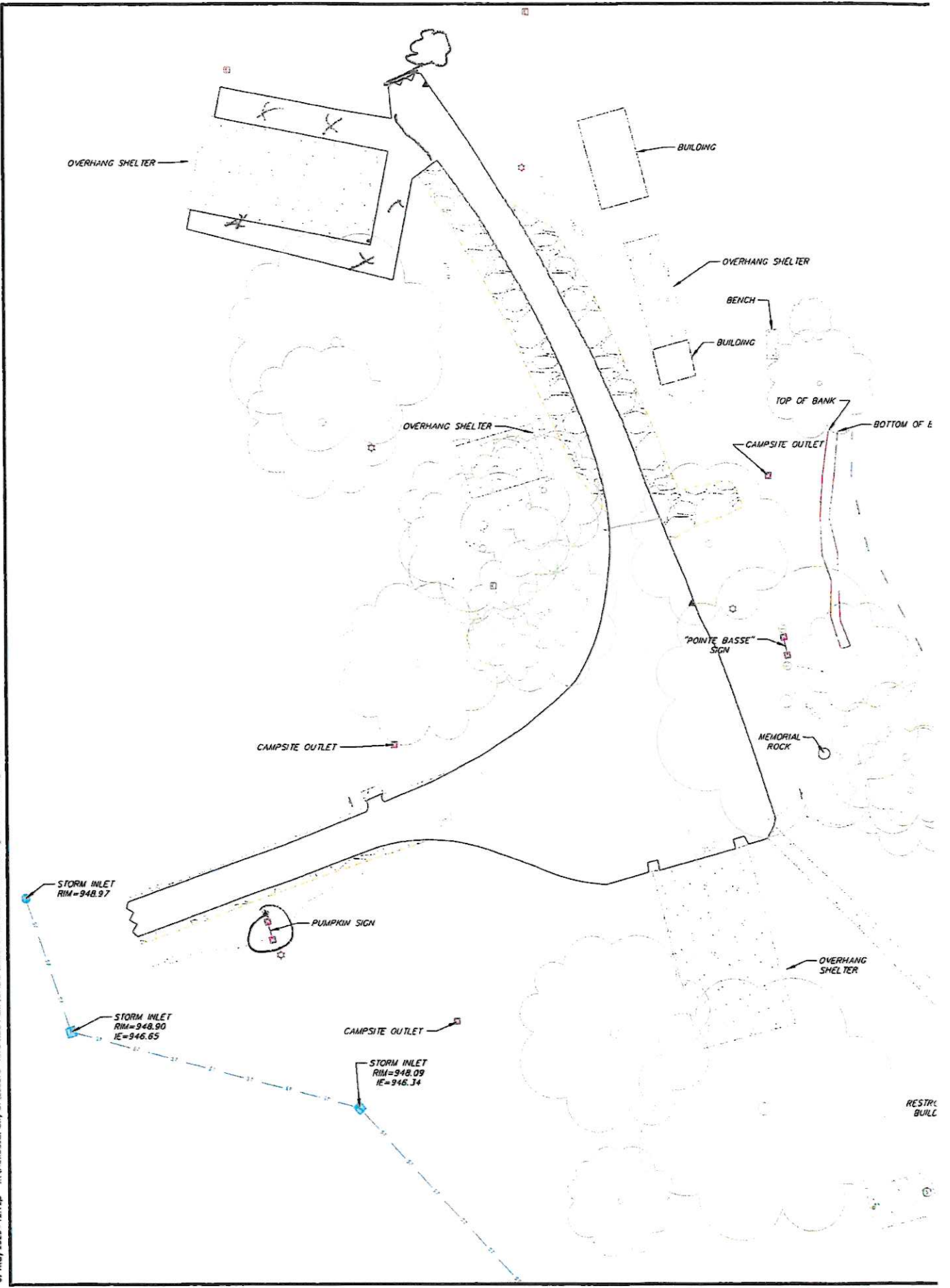



WOOD COUNTY LAND RECORDS VIEWER

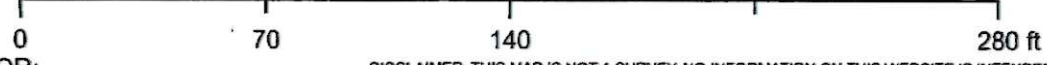

AUTHOR:

DATE PRINTED: 3/5/2026 8:38 AM

DISCLAIMER: THIS MAP IS NOT A SURVEY. NO INFORMATION ON THIS WEBSITE IS INTENDED TO SERVE AS LEGAL EVIDENCE OF SIZE, SHAPE, LOCATION OR OWNERSHIP OF REAL ESTATE OR ENVIRONMENTAL FEATURES. WOOD COUNTY ASSUMES NO LIABILITY RELATED TO THE USE OF THIS MAP.

